

HSS Hire Shops



Cartridge Hammers

The HILTI CARTRIDGE HAMMER:
 This offers a fast, efficient way to make reliable fixings in masonry and steel.
 Two models, the single shot DX 450 or the multi shot, magazine fed DXA41.



Code 52245 & 52250

FINISHING OFF

Pull the cartridge strip out through the top of the tool and **place spare nails and cartridges, in the tool's carrying case. Remove any remaining nails from the magazine of the DXA41.**

Finally, **clean off any dust and dirt before packing the tool away in its case and returning it** to your local HSS Hire Shop so that we can dispose of unused cartridges correctly and safely.

The Good Fixing Guide

Timber to Concrete:	22-32mm
Timber to Brickwork:	Variable (test first)
Steel to Steel:	10-14mm
Timber to Steel:	17-27mm

Note: Select nail length by adding above depth to thickness of item to be secured

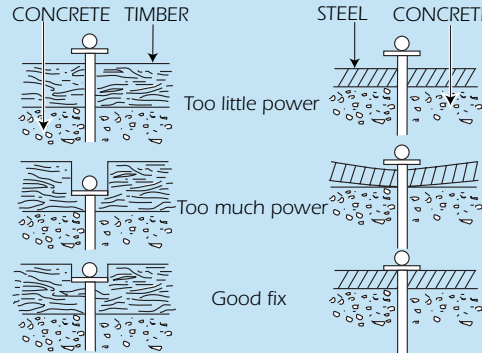

Example showing nail fixing timber to concrete

Example showing nail fixing steel to concrete

Misfires

If the cartridge hammer fails to fire, continue to hold it against the work for at least 30 seconds before assuming the cartridge has failed.

You can then try again, advancing a fresh cartridge into the firing position by operating the cocking lever as if you were loading a new nail or by pulling the cartridge strip up one position on the DXA41 and trying again.

Always point the tool at the ground while doing this. Never look down the barrel. If the cartridge hammer fails a second time, wait a further 30 seconds, remove the cartridge strip and place in the tool box and mark it.

Strips containing faulty cartridges should be returned to your nearest HSS Hire Shop and the manager informed. Do not dispose of them in any way.

steel, edges should be at least 15mm away; 80mm in concrete. **Do not try to make a fixing twice in the same place.**

EQUIPMENT CARE

Never push the equipment beyond its design limits. If it will not do what you want with reasonable ease and speed, assume you have the wrong tool for the job. Contact your local HSS Hire Shop for advice.

When not in use, store the equipment somewhere dry, away from heat/ignition sources and safe from thieves.

Use only nails and cartridges supplied by HSS. Those from any other source may be dangerous and could damage the tool.

Overdriving

Over-driving normally results from using fixings that are too short, but it can happen accidentally – if the material you are driving into is flawed. Whatever the cause, it may damage the stop ring/ rubber buffer – so, if you find loading a nail requires more force than usual or that the automatic loading cycle on the DXA41 fails, return the tool to your local HSS Hire Shop for exchange.



©HSS Hire Service Group Plc 1996 No. 550/01

Group Office: 25 Willow Lane, Mitcham, Surrey CR4 4TS

GENERAL SAFETY

Keep children and animals out of the work area.



Wear practical, protective clothing and footwear, plus **safety goggles**. Avoid loose garments and jewellery that could get in the way.



Note that this equipment generates **potentially harmful noise levels**. To comply with Health and Safety at Work regulations, **ear defenders must be worn** by everyone in the vicinity.

The tool must only be operated by adults over 18 who have read and understood these instructions.

Never use this equipment if you are ill, feeling tired, or under the influence of alcohol or drugs.

Never load the tool until you are ready to use it to make a fixing and, **once loaded, never point it at anyone** – including yourself.

Never use the tool if anyone is close enough to be at risk from flying debris or mis-fires.

Never use the tool in fume/gas-laden atmospheres where there is a risk of explosion or fire – for example, in paint stores and sewers.

Make sure of your footing before operating the tool. Never work from an unstable platform such as ladders, steps or anywhere else where there is a risk of slipping or falling – the recoil could throw you off balance.

Never make fixings in anything containing hidden pipes or electrical wiring. If in doubt, use a metal detector or Cable Avoiding Tool to locate such hazards.

Before cleaning or making any adjustments to the tool, **unload it** by pulling the cartridge strip out through the top.

Never leave the tool loaded and unattended – even for a moment.

Store the tool (together with spare cartridges and fixings) in its case, somewhere it cannot be reached by children or unauthorised users.

GETTING STARTED

Ensure the method of fixing is appropriate to the object being fixed. The base material should be at least 10mm thick and resistant to impact damage.

Ensure the method of fixing is suitable for the surface you are fixing to, for example concrete, brick and steel. In particular, the tool should not be used to make fixings in partition walls, ceilings, soffits.

Select the appropriate cartridge for the job. In most cases, standard red cartridges are more than adequate. However, there may be times (when fixing into steel)

when the more powerful black cartridges are needed. If in doubt contact your local HSS Hire Shop for advice.

Adjust the tool's power regulator to give the required penetration. Start at the number 1 setting, make a test fixing (see Basic Techniques) then reset the regulator dial if required and re-test until you have an acceptable fixing. (On the DXA41 this is done by pushing down and turning the power regulator dial).

BASIC TECHNIQUES

To load the DXA41, open the magazine by pushing in the catch and sliding the cover away from the tool, insert the strip of nails into the guide with points facing outwards. Close the cover by sliding it back onto the magazine.

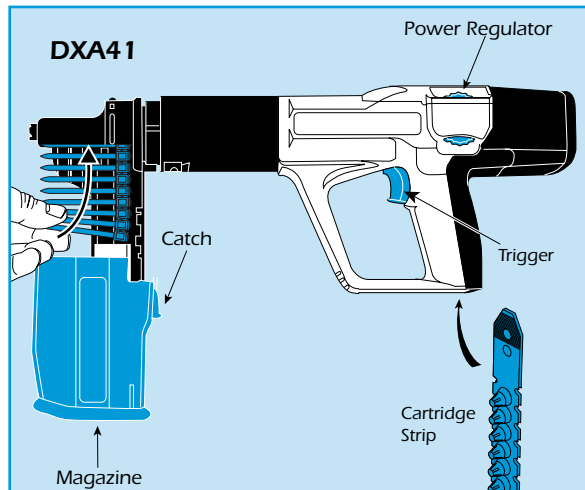

Feed the cartridge strip into the bottom of the tool's grip as far as it will go. You are now ready to fire.

To load the DX450, hold with its fastener guide pointing upwards and slide the nail, point first, into the hollow cocking lever. Pull back the loading grip, and pivot the cocking lever until it lines up with the fastening guide.

Now slide the loading grip along the cocking

Long Nails DX450 Only

Some jobs require nails too long to be loaded into the cartridge hammer in the normal way. The trick is to pre-drive the nail with a hammer to the depth of the plastic collar. That done, locate the nail head in the fastener guide and operate the tool normally to drive it home.

lever as far as it will go to ram the nail home, then return the lever to its starting position.

Finally, feed the cartridge strip into the bottom of the tool's grip until the tab protrudes from the top of the tool. You are now ready to fire.

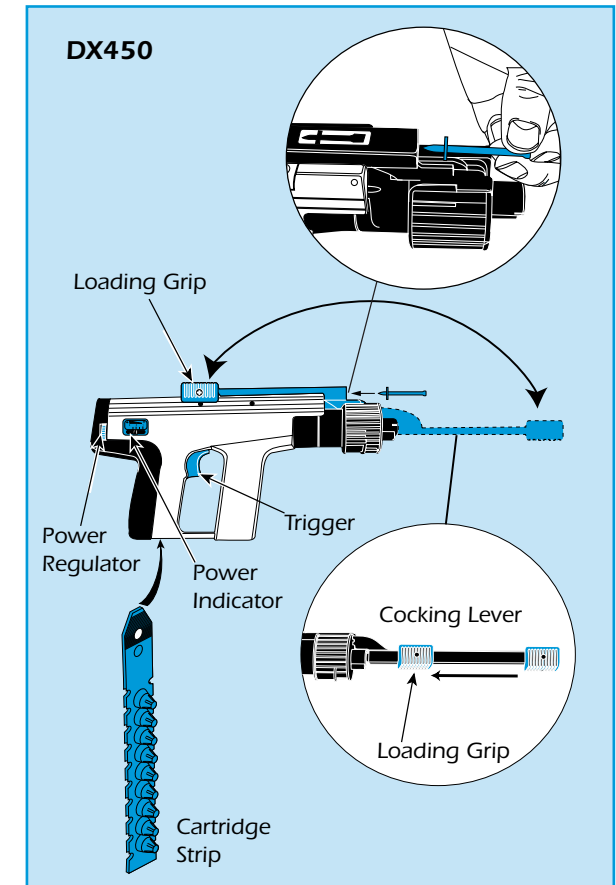

To make the fixing, hold the tool with both hands and press the fastener guide against the work until the nose-piece is fully compressed – you may hear a click as the fastener guide slides back and arms the firing mechanism.

Now, having braced yourself against the recoil, squeeze the trigger and the tool should fire.

On the DXA41 subsequent fixings are automatically loaded ready for firing – the mechanism does not have to be cocked each time.

For the DX450, load the nail as described above. The cartridge strip will automatically advance ready for firing.

Do not drive nails near the edges or corners. In