

BASIC TECHNIQUES

Inspect the hedge to be trimmed. Check that there are no wires, electric cables or any other obstructions running through it.

Think before you cut, ensure that cuttings fall away from you. Clear the work area and remove trip hazards.

Hold the trimmer with both hands, adopting a stable stance that lets you see what you are doing but keeps you safely clear of the cutters.

Keep the power supply cable clear of the blades, drape it over your shoulder.

Sweep the blades over the hedge, working from the ground upwards.

The trimmer can cut a maximum thickness of 16mm and this must not be exceeded. If you encounter a thick stem, stop the hedge trimmer and use a pruning saw to cut through the obstruction.

Never over-reach or work above chest height. Keep the work area tidy, regularly sweep up trimmings.

WATCH YOUR FOOTING. Be careful not to trip or slip while operating the equipment.

Between cuts and when moving location, **turn the hedge trimmer OFF.**

Do not allow the blades to come into contact with soil or similar substance. **Switch OFF** and allow the blades to stop moving **before removing any debris from them.**

EQUIPMENT CARE

Never push the equipment beyond its design limits. If it will not do what you want with reasonable ease and speed, assume you have the wrong tool for the job. Contact your local HSS Hire for advice.

Keep the equipment clean - you will find this less of a chore if you clean it regularly, rather than wait until the end of the hire period.

To maintain cutting efficiency, regularly lubricate the blade with light oil.

ALWAYS cover the blade with the protective sheath when the unit is not in use.

When not in use, **store the equipment somewhere clean, dry and safe** from thieves.

FINISHING OFF

Switch the trimmer OFF and unplug it from the power supply.

Replace the protective sheath onto the blade.

Neatly coil the power supply cable away from the cutters ready for return, to your local HSS Hire.



... have you been trained

The law requires that personnel using this type of equipment must be competent and qualified to do so. Training is available at HSS Training Solutions
0845 766 7799

...any comments?

If you have any suggestions to enable us to improve the information within this guide please e-mail your comments or write to the Safety Guide Manager at the address below
e-mail: safety@hss.com

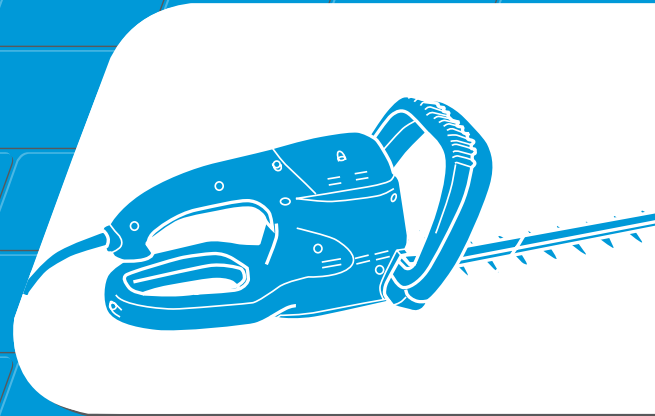

Electric Hedge Trimmers

Suitable for trimming hedges in the smaller garden



©HSS Hire Service Group Ltd 2007 No. 374/02

Group Office: 25 Willow Lane, Mitcham, Surrey CR4 4TS

Web Site: <http://www.hss.com>

Code 62412

GENERAL SAFETY

For advice on the safety and suitability of this equipment contact your local HSS Hire.

There is a serious risk of personal injury if you do not follow all instructions laid down in this guide.

The hirer has a responsibility to ensure that all necessary risk assessments have been completed prior to the use of this equipment.

This equipment should only be used by an operator who has been deemed competent to do so by his/her employer.

This equipment should be used by an able bodied, competent adult who has read and understood these instructions. Anyone with either a temporary or permanent disability, should seek expert advice before using it.

Keep children, animals and bystanders away from the work area. Cordon off a NO GO area using either cones, barriers or tape, available for hire from your local HSS Hire.

 Never use this equipment if you are ill, feeling tired, or under the influence of alcohol or drugs.

 Safety goggles MUST be worn by everyone in the work area.

 This equipment generates potentially harmful noise levels. To comply with health and safety at work regulations, ear defenders must be worn by everyone in the vicinity.

 Wear practical, protective clothing, gloves and footwear. Avoid loose garments and jewellery that could catch in moving parts, tie back long hair.

Watch your footing. Think twice before working anywhere other than on firm, level ground. Never work in slippery or wet conditions or near overhead cables.

Do not disconnect or bypass safety controls – they are there to protect you.

Always use a suitable stable work platform e.g. staging, when working above ground level – never work from a ladder.

Keep a firm grip on both handles whilst trimming. Hedge trimmers can cause serious injury. Always keep feet and hands well away from the cutting blade.

Never lift or move this equipment by its power supply cable.

Always switch OFF and unplug the equipment when not in use.

Make sure you know how to switch this machine OFF before you switch it ON in case you get into difficulty.

Always disconnect the machine from its power supply before making adjustments to it. Having switched OFF, always wait for moving parts to come to rest.

Make sure that everyone is warned of what you are doing. Check the condition of the equipment before use. If it shows signs of damage or excessive wear, return it to your

local HSS Hire.

Ensure the blade's protective sheath is correctly fitted before transporting the trimmer.

COSHH information sheets are available from your local HSS Hire.

ELECTRICAL SAFETY

The HSS Electric Hedge Trimmer plugs into a standard 230V 13amp power socket.

If the equipment fails, or if its power supply cable or plug becomes damaged, return it. Never try to repair it yourself.

Keep cables out of harm's way, and clear of the work area. Extension leads should be fully unwound and loosely coiled, away from the equipment. Never run them through water, over sharp edges or where they could trip someone.

Keep the equipment dry, using electrical equipment in very damp or wet conditions can be dangerous.

 To reduce the risk of electric shock, only use the RCD (Residual Current-Operated Device) protected lead supplied with the trimmer.

The RCD lead supplied with this machine is there to protect you. DO NOT ADAPT OR BY-PASS ITS USE.

If you cut the cable, isolate the lead from the power supply and contact your local HSS Hire.

Ensure the machine and power socket are switched OFF before plugging into the power supply.

GETTING STARTED

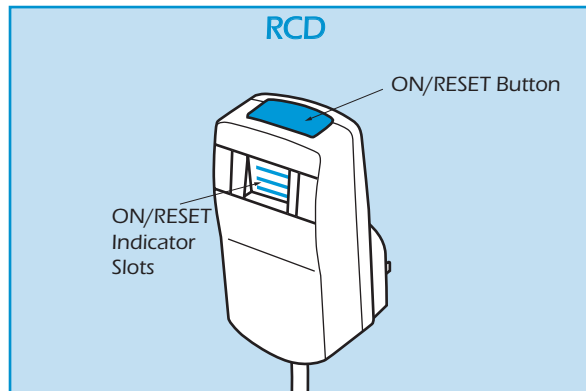

Remove the protective sheath from the blades.

Plug the RCD lead into a suitable power supply and switch the supply ON.

Set the RCD to ON by pressing the ON button, the ON/OFF.

Test the RCD by pressing the ON button a second time. It is essential to familiarise yourself with all the controls before starting.

Depress the finger trigger and squeeze the hand grip (front of machine) simultaneously to operate the machine. On some models there are three finger triggers to choose from, depending on what angle you are holding the unit.

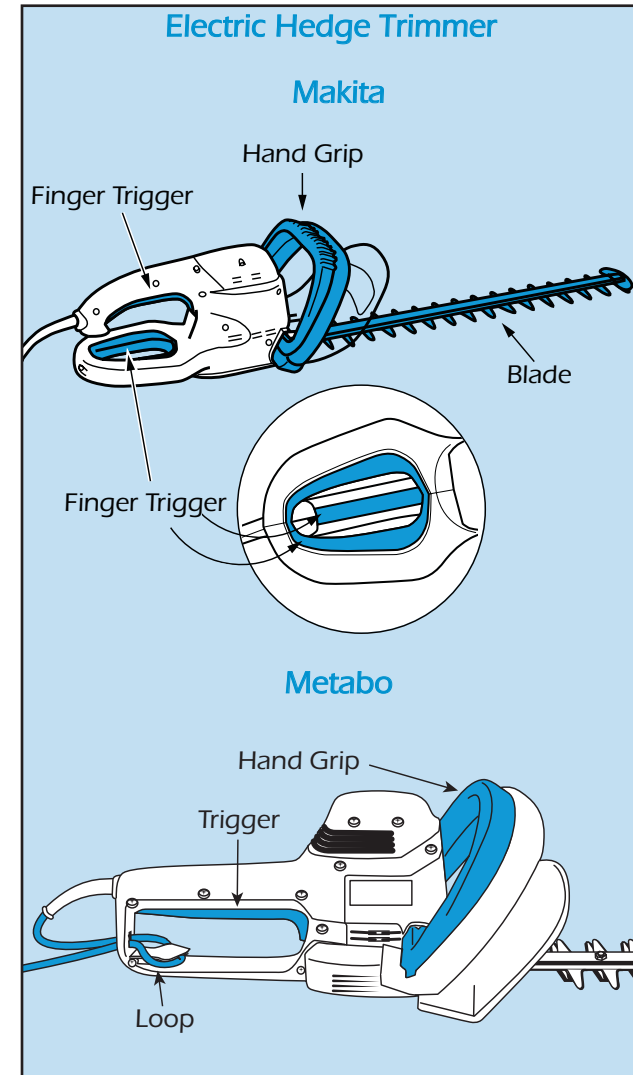

The machine will not start until both trigger and handgrip are engaged.

If either trigger or handgrip are released, the motor and blades will stop almost immediately.

Where fitted, ensure the cable is looped at the rear of the handle assembly.