

Adopt a stable, comfortable stance - one that gives a good view of the cut.

Place the palm of your hand onto the Operators Presence Lever (OPL), then squeeze the throttle trigger to **bring the engine up to maximum speed and cut vertically downwards in a straight line** without forcing the chain through the wood.

Keep your right hand on the throttle grip and your left hand on the shaft at all times.

When cutting, the pruner MUST NOT be operated at angles greater than 60 degrees. Never allow yourself to be positioned under the cut.

If pruning at low level, do not cut lower than 300mm above soil level and never use the pruner to cut roots (this includes stumps previously pulled from the ground). Remember, soil is the chain's worst enemy and will blunt a chain in seconds!

To ensure the chain does not 'kick back' out of control, always **cut with the underside of the guide bar nearest the pruner body**, keeping the front of the pruner body against the wood by **using the pruner's finger bar. Never cut with the tip or top edge of the guide bar** (see illustration).

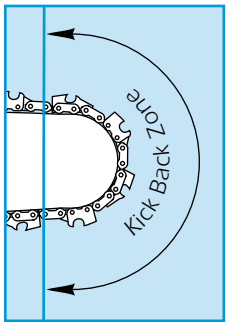

Never let the chain touch the ground, nor any metal or masonry obstructions. This will cause 'kick back' and will damage the blade.

If the pruner does 'kick-back', switch the engine OFF immediately.

If the chain becomes trapped in a cut, switch OFF the pruner before freeing it. Do not lever the chain free or you will

damage the pruner.

Ensure you **stand clear of the pruner as it completes the cut**. Having finished a cut, **switch OFF before moving on to another branch**.

Do not cut through branches that are under tension unless you have been specially trained.

Take your time and don't over do it. You are more likely to have an accident if you are tired or rushing.

Keep the work area tidy. Regularly sweep up any debris.

EQUIPMENT CARE

Never push the equipment beyond its design limits. If it will not do what you want with reasonable ease and speed, assume you have the wrong tool for the job. Contact your local HSS Hire Shop for advice.

Keep the engine upright at all times. If it should get tipped over, mop up any fuel spillage and contact your local HSS Hire Shop for advice.

Regularly check the fuel level and top up as necessary using 2-stroke oil and unleaded petrol mixed as directed on the 2-stroke oil container.

Check the chain oil reservoir level every 20 minutes of use and fill as necessary. Switch the engine OFF and wait for the engine to stop then for additional safety, replace the chain cover. Open the reservoir cap and top the reservoir with clean chain oil (available from your local HSS Hire Shop). **Replace the cap and ensure it is secure.**

Handle the equipment with care. Avoid dropping it, knocking it, or otherwise exposing it to damage.

Keep the equipment clean - you will find this less of a chore if you clean it regularly, rather than wait until the end of the hire period.

When not in use, **store the equipment somewhere clean, dry and safe** from thieves.

FINISHING OFF

Switch the engine OFF and replace the chain cover. Give the unit a final clean up ready for return, to your local HSS Hire Shop.



...any comments?

If you have any suggestions to enable us to improve the information within this guide please fax your comments or write to the Product Manager at the address below

Fax: 020 8687 5001

©HSS Hire Service Group Plc 2000 No. 979/01
Group Office: 25 Willow Lane, Mitcham, Surrey CR4 4TS

Web Site: <http://www.hss.co.uk>

HSS Hire Shops

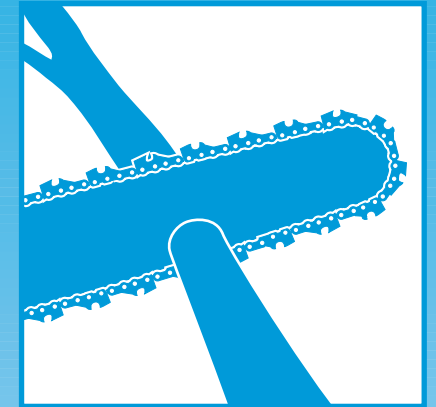

Two Stroke Pruner

The fast, effective way to prune and pollard trees and dense bushes.

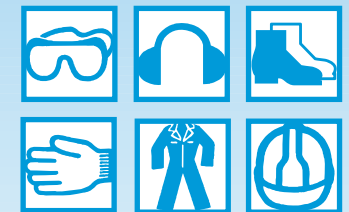

GENERAL SAFETY

For advice on the safety and suitability of this equipment contact your local HSS Hire Shop.

There is a serious risk of personal injury if you do not follow all instructions laid down in this guide.

The hirer has a responsibility to ensure that all necessary risk assessments have been completed prior to the use of this equipment.

This equipment should only be used by an operator who has been deemed competent to do so by his/her employer.

This equipment should be used by an able bodied, competent adult who has read and understood these instructions. Anyone with either a temporary or permanent disability, should seek expert advice before using it.

Keep children, animals and bystanders a minimum of 15m away from the work area. Cordon off a NO GO area using cones and either barriers or tape, available for hire from your local HSS Hire Shop.

Ensure you know how to stop the engine quickly in case someone enters the work area.

Due to the nature of this equipment, no one else may be present when being used. Having said that, do not use the pruner unless you are in sight of someone who can summon help in the event of an accident.

 Never use this equipment if you are ill, feeling tired, or under the influence of alcohol or drugs.

 A full face shield MUST be worn by everyone in the work area.

 This equipment generates potentially harmful noise levels. To comply with health and safety at work regulations, ear defenders must be worn by everyone in the vicinity.

    Wear practical, protective clothing, gloves, hard hat and footwear. Avoid loose garments and jewellery that could catch in moving parts, tie back long hair.

Exhaust Danger

NEVER operate petrol engines indoors or in a confined space.

The exhaust contains gases that can kill.

Ensure the work area is well lit and ventilated, if in doubt, ask about lighting and ventilation equipment at your local HSS Hire Shop.

Fuel Safety

NEVER refuel while the engine is hot or running.

Never smoke or allow naked lights into the area while refuelling.

Never inhale fuel vapour.

ALWAYS mop up any spillage as quickly as possible, and change your clothes if you get fuel on yourself.

ALWAYS store fuel in a purpose-made sealed container, in a cool, safe place well away from the work area.

Engines, especially the exhausts, get very hot so switch OFF and allow to cool before touching them.

Keep flammable materials well away from engine and exhaust.

Never leave the engine running and unattended.

Do not work near flammable gases or liquids, petrol or paint thinner fumes for example. Keep combustible materials at a safe distance - at least 5 metres.

Make sure you know how to switch this machine OFF before you switch it ON in case you get into difficulty.

Always switch OFF the engine when not in use and replace the chain cover, never leave it running and unattended.

NEVER use the half throttle lock button during use, this is ONLY fitted to aid starting the engine.

Think before you cut. Work out where the branch will fall and clear the danger area. Remove trip hazards and ensure you have a clear emergency escape route.

Watch your footing. Think twice before working anywhere other than on firm, level ground. Never work in slippery or wet conditions.

Check the condition of the equipment before use. If it shows signs of damage or excessive wear, return it to your local HSS Hire Shop.

Ensure the guard is correctly fitted and secure before starting work.

GETTING STARTED

Fit the clip-on shoulder harness to the pruner and adjust it so that the machine feels comfortable and balanced. Do not use the machine without the harness, as both hands must be free to control the machine.

Now unclip the machine from the harness.

Check that the chain oil reservoir is full and top up with non-fling chain oil if necessary (available from your local HSS Hire Shop). Continue to check the oil level at 15 - 20 minute intervals. Clean the filler cap before removing or replacing it.

Mix 2-stroke oil with unleaded petrol in a suitable container, as directed on the sachet, and fill the fuel tank. Never add oil and petrol to the tank unmixed.

Set the machine on a firm level surface with the chain clear of the ground and clear of any obstructions as it will rotate as soon as the engine fires.

The unit is fitted with an operators' presence lever (OPL), the throttle can not be operated unless the OPL is firstly depressed.

To start the engine, the OPL and throttle must be locked in position. To do this, place the palm of your hand on to the OPL, squeeze in the throttle and move the ON/OFF/Start switch to the Start position.

Hold the switch in the Start position and release the throttle and OPL.

The throttle is now locked in the halfway position ready for starting the engine.

Please note that the throttle lock system MUST NOT be used during normal operation.

Set the choke lever down to the 'CLOSE' position.

Hold the unit firmly by the clutch housing (see illustration) to stop it lifting, then pull the pull-start two or three times and the engine should start.

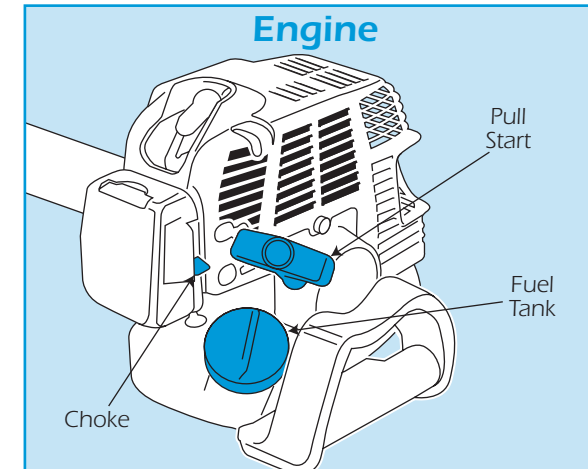

Once started, 'OPEN' the choke (move the lever up) then squeeze and release the throttle and allow the engine to warm up.

To stop the engines simply move the ON/OFF/Start switch to OFF. Familiarise yourself with the switch and its location so that you can operate it quickly in an emergency.

Two Stroke Pruner

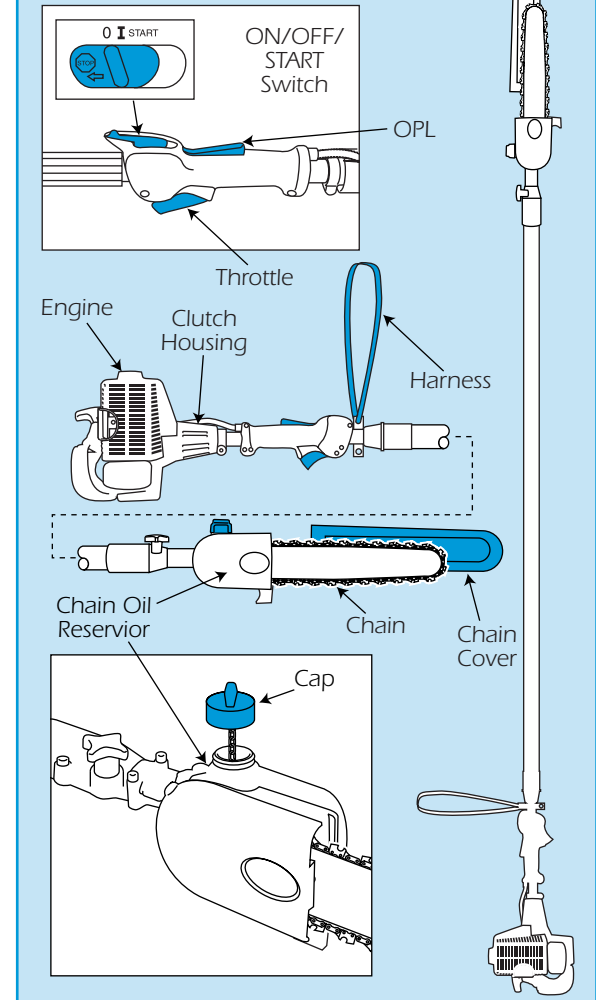

If the engine floods, open the choke, lock the throttle full on, then pull the starter cord until the engine starts

The chain is now free to rotate as soon as the throttle is operated.

BASIC TECHNIQUES

With the engine running, clip the unit to the shoulder harness making any adjustments for comfort.

ALWAYS operate the machine using both hands to control it.

Watch your footing, be careful not to trip or slip while operating the equipment.