

Next, lower the table top then release the wheelbrake before you move the unit to the unloading area. **KEEP YOUR HANDS AND FEET CLEAR OF THE SCISSOR ASSEMBLY AT ALL TIMES.**

Once at the unloading area, raise the table again to the height required, ensuring the caster lock is ON.

Do not allow the Scissor Lift Table to travel at speed or change its direction of travel abruptly.

EQUIPMENT CARE

Never wheel the Scissor Lift Table over rough ground. It damages the equipment and could prove to be extremely dangerous.

When not in use, store the equipment somewhere clean, dry and safe from thieves.

FINISHING OFF

Thoroughly clean the Scissor Lift Table, ready for return to your local HSS Lift & Shift Depot.



...any comments?

If you have any suggestions to enable us to improve the information within this guide please fax your comments or write to the Product Manager at the address below

Fax: 0181-687 5001

©HSS Hire Service Group Plc 1998 No. LS23/01

Group Office: 25 Willow Lane, Mitcham, Surrey CR4 4TS

Web Site: <http://www.hss.co.uk>

Operating & Safety Guide LS23

HSS Lift & Shift

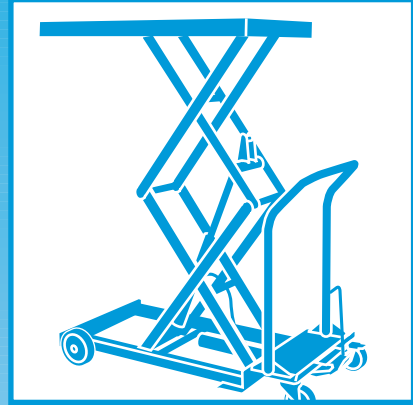

Scissor Lift Tables

Ideal where loading and unloading areas are at different heights.



Code 70241/4/7

GENERAL SAFETY

For advice on the safety and suitability of this equipment contact your local HSS Lift & Shift Depot.

There is a serious risk of personal injury if you do not follow all instructions laid down in this guide.

This equipment is designed to be used by an able bodied, competent adult who has read and understood these instructions. Anyone with either a temporary or permanent disability, should seek expert advice before using it.

Keep children, animals and bystanders away from the work area.

 Never use this equipment if you are ill, feeling tired, or under the influence of alcohol or drugs.

 Wear practical, protective clothing, gloves, footwear. Avoid loose garments and jewellery that could catch in moving parts, tie back long hair.

 Use this equipment for vertical lifts only on a smooth, level floor able to take the combined weight of the load and the equipment.

 Ensure the load is balanced and stable and that personnel stand clear of the raised load.

Make sure you know how to operate this equipment safely and are aware of its limitations before you use it.

It is both the hirers and the operators responsibility to perform a risk assessment before assembling or using this equipment. You are also responsible for the safety of anyone in the work area.

Make sure that anyone in the immediate work area is warned of what you are doing. Never allow anyone under a raised load or in a position where they are at risk if the load shifts.

Never leave the equipment loaded or unattended.

This equipment **MUST NOT** be used to carry personnel.

Never exceed the tables safe working load, see chart.

Check the condition of the equipment before use.

Dimensions & Safe Working Loads

COMM CODE	Max. Lift (mm)	Table size (mm)	Max. SWL
70241	1500	610 x 1030	450Kg
70244	1050	850 x 1350	1250k
70247	880	500 x 1000	1500kg

If it shows signs of damage or excessive wear, return it to your local HSS Hire Shop.

Ensure the work area is well lit.

Use the equipment only on firm, level ground. When moving loads keep to a sensible pace. If you go too fast, or if you try to wheel a heavy load down a slope, it could run away with you.

GETTING STARTED

The Scissor lift table has 2 foot controls. The first is the hydraulic pump foot lever. When pumped up and down, the table will rise.

The second control is the Hydraulic release foot lever. When pressed down the table will lower.

Scissor Lift Table

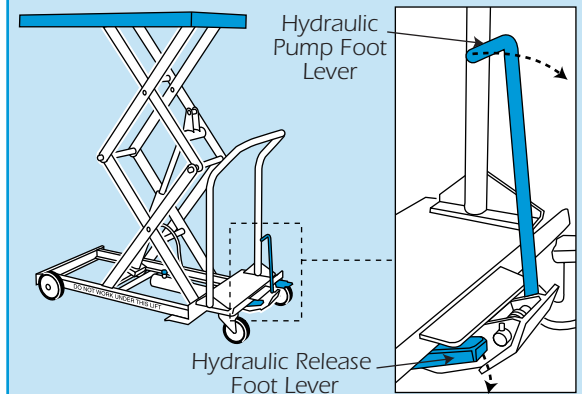

BASIC TECHNIQUES

Press the release lever and confirm that the table is in its lowest position.

Move the unit to the load, then pump the hydraulic pump lever until the table top is in line with the base of the load.

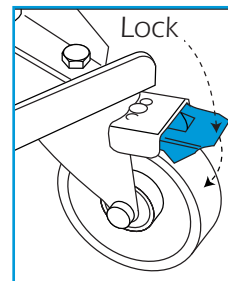

For safety reasons you are advised to set the caster wheel brake lever ON.

You can now place the load on to the table.

When loading and unloading, make sure that the weight is evenly distributed to avoid the load becoming unstable. And avoid piling the load up too high, it could topple.