

Move over the surface in small rotations, until the surface is fully cleared.

Take your time and don't overdo it. You are more likely to have an accident if you are tired or rushing.

## EQUIPMENT CARE

This machine is only for **LIGHT WORK** and is not designed for continuous use. After 15min of work, switch the unit **OFF** and leave to cool for a further 15 minutes.

Failure to observe this rule will cause irreparable damage to the motor and the impact mechanism.

Never push the equipment beyond its design limits. If it will not do what you want with reasonable ease and speed, assume you have the wrong tool for the job. Contact your local HSS Hire Shop for advice on the heavier duty air models.

Keep the equipment clean, you will find this less of a chore if you clean it regularly, rather than wait until the end of the hire period.

When not in use, store the equipment somewhere clean, dry and safe from thieves.

## FINISHING OFF

Switch **OFF** and unplug the equipment.

Clean off any loose dust, paying special attention to motor ventilation slots.

Neatly coil the power supply cable and give the tool a final clean up ready for return, to your local HSS Hire Shop.



## ...any comments?

If you have any suggestions to enable us to improve the information within this guide please fax your comments or write to the Product Manager at the address below

Fax: 0181-687 5001

©HSS Hire Service Group Plc 1998 No. 630/01

Group Office: 25 Willow Lane, Mitcham, Surrey CR4 4TS

Web Site: <http://www.hss.co.uk>

## Operating & Safety Guide 630

# HSS Hire Shops

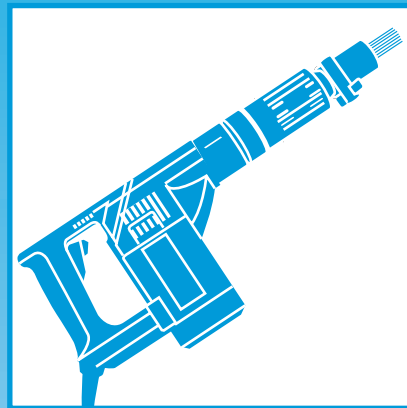

## Light Duty Needle Scaler

The convenient way to clean concrete, masonry and steel of light deposits, without the need of a compressor.



Code 02411

## GENERAL SAFETY

For advice on the safety and suitability of this equipment contact your local HSS Hire Shop.

This equipment should be used by an able bodied, competent adult who has read and understood these instructions. Anyone with either a temporary or permanent disability, should seek expert advice before using it.

Keep children, animals and bystanders away from the work area.



Never use this equipment if you are ill, feeling tired, or under the influence of alcohol or drugs.



Safety Goggles MUST be worn by everyone in the work area.



Some materials when removed by this process contain substances which, when inhaled, can be harmful to health. A suitable mask must be worn when using this equipment. Respiratory protective equipment is available for hire, contact your local HSS Hire Shop for details.



This equipment generates potentially harmful noise levels. To comply with health and safety at work regulations, ear defenders must be worn by everyone in the vicinity.



Wear practical, protective clothing, gloves and footwear. Avoid loose garments and jewellery that could catch in moving parts, tie back long hair.

Ensure the work area is well lit and ventilated, if in doubt, ask about ventilation equipment at your local HSS Hire Shop.

Do not work near flammable gases or liquids, petrol or paint thinner fumes for example. Keep combustible materials at a safe distance – at least 5m.

Make sure you know how to switch this machine OFF before you switch it ON in case you get into difficulty.

Always switch OFF and unplug the machine before making adjustments to it.

Never carry or pull the equipment by its power supply cable.

Check the condition of the equipment before use. If it shows signs of damage or excessive wear, return it to your local HSS Hire Shop.

If working above ground-level, work from a stable, purpose-made platform. Steps and ladders are fine for gaining access and as work platforms for small, light jobs, but for prolonged, heavy work, an access tower or something similar is a must.

Watch your footing. Take special care if working other than on firm, level ground.

## ELECTRICAL SAFETY

Most HSS Light Duty Needle Scalers plug into a standard 240v 13amp power socket. However, 110v models (with a round yellow plug) must be provided

## Needle Scaler

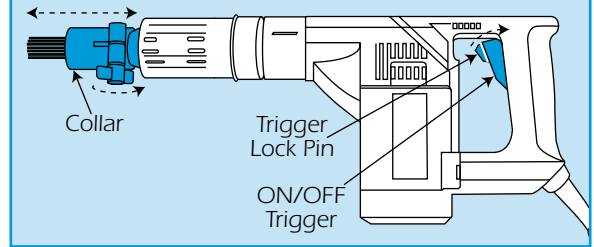

with a suitable 110v generated supply, or powered from the mains via a suitable 110v transformer (minimum 2.2kva tool rating).

If the equipment fails, or if its power supply cable or plug becomes damaged, return it. Never try to repair it yourself.

Keep cables out of harm's way, and clear of the work area. Extension leads should be fully unwound and loosely coiled, away from the equipment. Never run them through water, over sharp edges or where they could trip someone.

Using electrical equipment in very damp or wet conditions can be dangerous.

 To reduce the risk of electric shock, use a suitable RCD (Residual Current-Operated Device) available from your local HSS Hire Shop.

Ensure the Needle Scaler and power socket are switched OFF before plugging into the power supply.

## GETTING STARTED

Make sure the area to be cleaned is well lit and ventilated. Remove the unit from its case.

Adjust the front nose collar to suit the particular job, the further back the looser the needles movement will be. In general, slide the collar forward for fine surfaces and back for rough surfaces.

The unit is fitted with a variable speed trigger. The further in the trigger is squeezed, the faster the needles will vibrate.

To switch the unit ON squeeze in the ON / OFF trigger, to hold at max lift the lock pin and release the trigger.

To stop the unit, squeeze the trigger again and then release.

Familiarise yourself with the switches and their location so that you can operate them quickly in an emergency.

All that remains is to plug the Needle Scaler into its power supply and switch the supply ON.

## BASIC TECHNIQUES

Always position yourself so you can control the Scaler while staying clear of the debris it creates.

Switch the unit ON and offer the tips of the needles up to the surface. Use as little pressure as possible, allowing the unit to work at its own pace.