



## Air Mover

An electrically operated unit for the removal of fumes from work areas and ventilating confined spaces. Approved for use in CENELEC zone I & 2.



Code 56830

### Air Mover Specification

Description	Air Mover Electrically Powered.
Code	EEx d IIB T4
Blow Rate	2,300 cfm (reduced to 1,550 cfm if the ducting is turned to 90°).
Power Source	240V.
Air Pressure	5.0 bar.
Weight	20 kg.
Conditions of Certification	Air ducting MUST be anti-static.

**Keep the equipment clean** – you will find this less of a chore if you clean it regularly, rather than wait until the end of the hire period.

When not in use, **store the equipment somewhere clean, dry and safe** from thieves.

#### FINISHING OFF

Switch the air mover OFF and wait until the fan blades have stopped.

Unplug the unit from its power supply then disconnect the ducting.

Neatly coil the power supply cable and collect all parts together ready for return, to your local HSS Safe and Sure Depot.



#### ... have you been trained

The law requires that personnel using this type of equipment in the workplace must be competent and qualified to do so.

Training is available at HSS Training  
0845 766 7799

#### ...any comments?

If you have any suggestions to enable us to improve the information within this guide please e-mail your comments or write to the Safety Guide Manager at the address below  
e-mail: [safety@hss.com](mailto:safety@hss.com)

©HSS Hire Service Group Ltd 2020 No. 2004/01

76 Talbot Road, Old Trafford, Manchester, M16 0PQ

[www.hss.com](http://www.hss.com)

## GENERAL SAFETY

For advice on the safety and suitability of this equipment contact your local HSS Safe and Sure Depot.

There is a serious risk of personal injury if you do not follow all instructions laid down in this guide.

The hirer has a responsibility to ensure that all necessary risk assessments have been completed prior to the use of this equipment.

This equipment should only be used by an operator who has been deemed competent to do so by his/her employer.

This equipment may be used in a workplace subject to a permit to work, it is the hirers responsibility to ensure that the equipment's technical specification meets the requirements of any such permit to work prior to starting work. For further technical information contact your local HSS Safe and Sure Depot.

This equipment should be used by an able bodied, competent adult who has read and understood these instructions. Anyone with either a temporary or permanent disability, should seek expert advice before using it.

Keep children, animals and bystanders away from the work area. Cordon off a NO GO area using cones and either barriers or tape, available for hire from your local HSS Safe and Sure Depot.



Never use this equipment if you are ill, feeling tired, or under the influence of alcohol or drugs.

Wear sensible, suitably protective clothing and footwear plus any safety wear appropriate to the work in progress.

Make sure you know how to operate this equipment safely and are aware of its limitations before you use it.

Remember that this equipment does not guarantee life protection but if used correctly it will help provide a safer environment to work in.

Make sure that anyone in the immediate work area is warned of what you are doing.

Check the condition of the equipment before use. If it shows signs of damage or excessive wear, return it to your local HSS Safe and Sure Depot.

## ELECTRICAL SAFETY

The HSS Air Mover is only available in 240V (fitted with a safety push and twist 16A round blue plug).

The plug fitted to this equipment is a safety push and twist type, this type of connection must be used in hazardous areas.

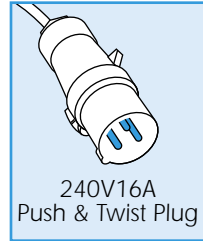

240V16A  
Push & Twist Plug

However, the push and twist plug will fit a standard 16A 240V socket. If in doubt contact your local HSS Safe and Sure Depot.

Extension leads, fitted with the correct plug and socket, should be fully unwound and loosely coiled, away from the work area.

Never run them through water, over sharp edges or where they could trip someone.

Keep the equipment dry. Using electrical equipment in very damp or wet conditions can be dangerous.



To reduce the risk of electric shock, always use a suitable RCD (Residual Current-Operated Device) available from your local HSS Safe and Sure Depot.

If the equipment fails, or if its plug or lead gets damaged, return it. Never try to repair it yourself.

Never carry or pull the equipment by its power supply cable.

Ensure the air mover and power socket are switched OFF before plugging into the power supply.

## GETTING STARTED

This equipment must only be used with the correct 'anti-static' ducting, the use of any other ducting will void the intrinsic safety certification.

Where required, the unit should be grounded by use of the earth connection (see illustration).

Closely inspect the ducting for signs of damage. If the wall of the ducting has been punctured, the unit must not be used. Contact your local HSS Safe and Sure Depot for a replacement.

Connect the ducting as required, i.e. either a section to the inlet or to the outlet dependant on where the fumes are being moved from (see diagram).

The ducting is supplied in 5 metre lengths, where a greater length of ducting is required, you may use additional air movers in tandem.

When setting the unit up, make sure it is pointing in the correct direction (see air flow direction arrow on the side of the air mover).

The ducting is secured to the air mover by a simple strap and clip. When fitting, ensure that the ducting completely covers the opening.

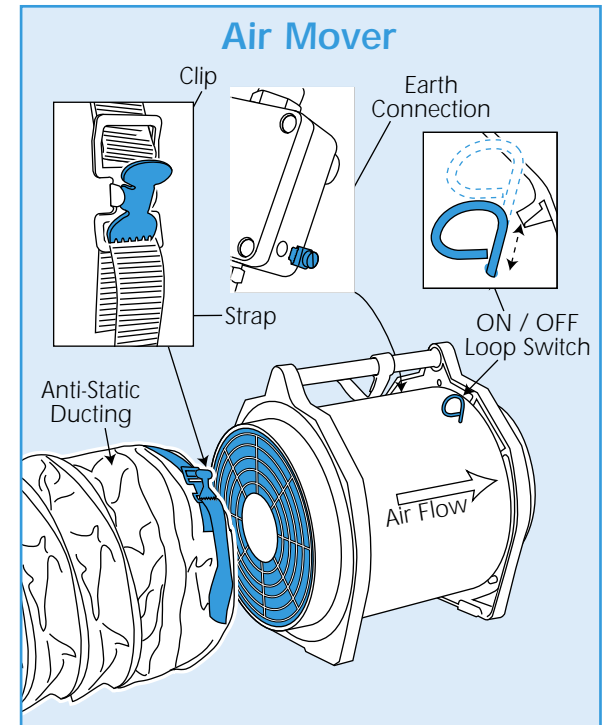

Ensure that the fumes are only discharged into the open air and away from any people. DO NOT discharge into another room.

To switch the unit ON simply raise the ON / OFF loop switch, to switch OFF, lower the switch.

## EQUIPMENT CARE

### Cleaning

The operator has a duty of care to ensure the equipment is returned clean of any potentially harmful contaminants.

Equipment that has not been cleaned will not be accepted back by HSS.

Never push the equipment beyond its design limits. If it is unsuitable for the task you are performing DO NOT USE OR RELY ON IT. Contact your local HSS Safe and Sure Depot for advice.

Handle the equipment with care. Avoid dropping it, knocking it, or otherwise exposing it to damage.

Never expose the equipment to excessive moisture, dust or dangerous/corrosive chemicals.

# Know Your Symbols

HSS have created clear Icons to inform the hirer of their responsibilities towards the safe use of hire equipment.

These are designed to reduce the amount of different safety information labels required for each product for hire.

## General use PPE / Warning

Clearly marked minimum PPE will be visible on all equipment,



Correct PPE must be worn



HAV Hand Arm Vibration



Danger Rotating blade



Danger Hot exhaust



Danger Electric shock



Caution Abrasive Wheel



Caution Finger trap

## Fuel and Supply Types



Pe  
Petrol



Di  
Diesel



2t  
2 - Stroke Petrol



EI  
Electric

## Safe Procedures

All hirers must understand and respect the safe procedures of all equipment.

It is the responsibility of the hirer to maintain and return the equipment in a clean condition and good working order.



Ro  
Read OPS Guide



Ou  
Outdoor Use only



HI  
Heavy Lifting



Cd  
Check Oil daily



Cf  
Check Fuel daily



Cw  
Check Water daily



Bc  
Battery Care



Sh  
Safe Height Working



Swl  
Refer to Data Plate



V  
Check Power Voltage Data Plate

## Electrical Safety

Safe wiring procedures.



Ea  
Must be Earthed Class 1

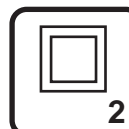

Doi  
Double Insulated Class 2



Enl  
Earth Live Neutral Wire Coding

## Return Responsibility

Charges apply to equipment returned dirty and damaged.



Cc  
Cleaning Charge



Rc  
Repair Charge