

# HSS Hire

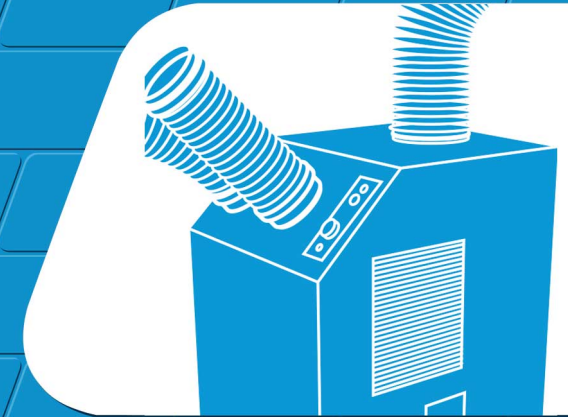

## Spot Cooler

A mobile air conditioning unit designed for cooling specific areas of a room, suitable for IT departments and personnel cooling.



Once the unit is running, allow a minimum of 10 minutes for it to begin cooling

Once the desired room temperature has been reached, gradually twist the thermostatic control dial anti-clockwise until you hear it click.

The unit will now only emit chilled air when the room temperature rises.

Do not force the thermostatic control dial past the stop point, you will damage the switchgear.

After a time (depending on the humidity in the surrounding air) the water tank will become full. There are two options available to you. Either wait until the unit switches itself OFF (the red 'empty when lit' lamp will illuminate) then empty the tank, or check the tank level periodically and empty before it becomes full.

In either situation, always switch the unit OFF and unplug it from its power supply.

### EQUIPMENT CARE

Never use the spot cooler except for its intended purpose, If it will not do what you want, assume you have the wrong equipment for the job. Contact your local HSS Hire Shop for advice.

Only use the spot cooler for the purpose it was designed for. Improper use may cause expensive damage and could be dangerous.

Keep the equipment clean. You will find it less of a chore if you clean it regularly, rather than wait until the end of the hire period.

Regularly check the water drain tank. If the unit stops and the 'empty when lit' lamp is illuminated, the tank will need emptying.

You should in any case, check the water level in the tank at least once a week, prior to switching it ON.

When not in use, store the equipment somewhere clean, dry and safe from thieves.

### FINISHING OFF

Switch the unit OFF and unplug it from the power supply, then empty the water tank.

Remove the exhaust and discharge hoses, then coil its power supply cable ready for return to your local HSS Hire Shop.



#### ... have you been trained

The law requires that personnel using this type of equipment in the workplace must be competent and qualified to do so.

Training is available at HSS Training  
0845 766 7799

#### ...any comments?

If you have any suggestions to enable us to improve the information within this guide please e-mail your comments or write to the Safety Guide Manager at the address below  
e-mail: [safety@hss.com](mailto:safety@hss.com)

©HSS Hire Service Group Ltd 2020 No. 949/01

76 Talbot Road, Old Trafford, Manchester, M16 0PQ

[www.hss.com](http://www.hss.com)

Code 56756

## GENERAL SAFETY

For advice on the safety and suitability of this equipment contact your local HSS Hire Shop.

This equipment should be used by an able bodied, competent adult who has read and understood these instructions. Anyone with either a temporary or permanent disability, should seek expert advice before using it.

Never use this equipment if you are ill, feeling tired, or under the influence of alcohol or drugs.

Never place anything on top of the unit and never obstruct its air vents. Leave a 300mm gap all round to let air circulate.

Always switch OFF and unplug the equipment when not in use.

Never carry or pull the equipment by its power supply cable or hose system.

Check the condition of the equipment before use. If it shows signs of damage, leakage or excessive wear, return it to your local HSS Hire Shop.

Always transport, store and operate this equipment in an upright position. If the unit has been laid on its side, DO NOT SWITCH IT ON, contact your local HSS Hire Shop for advice.

## ELECTRICAL SAFETY

The HSS Spot Cooler plugs into a standard 230V 13amp power socket.

If the equipment fails, or if its power supply cable or plug gets damaged, return it. Never try to repair it yourself.

Keep flexes out of harms way, and clear of moving parts.

Extension leads should be fully unwound and loosely coiled, away from the equipment. Never run them through water, over sharp edges or where they could trip someone.

Using electrical equipment in very damp or wet conditions can be dangerous.

 To reduce the risk of electric shock, always use a suitable RCD (Residual Current-Operated Device) available from your local HSS Hire Shop, or power the Spot cooler from a power circuit with a built-in RCD.

Ensure the Spot cooler and power socket are switched OFF before plugging into the power supply.

## GETTING STARTED

Never operate the unit in very cold conditions – its ideal working temperature is above 15°C.

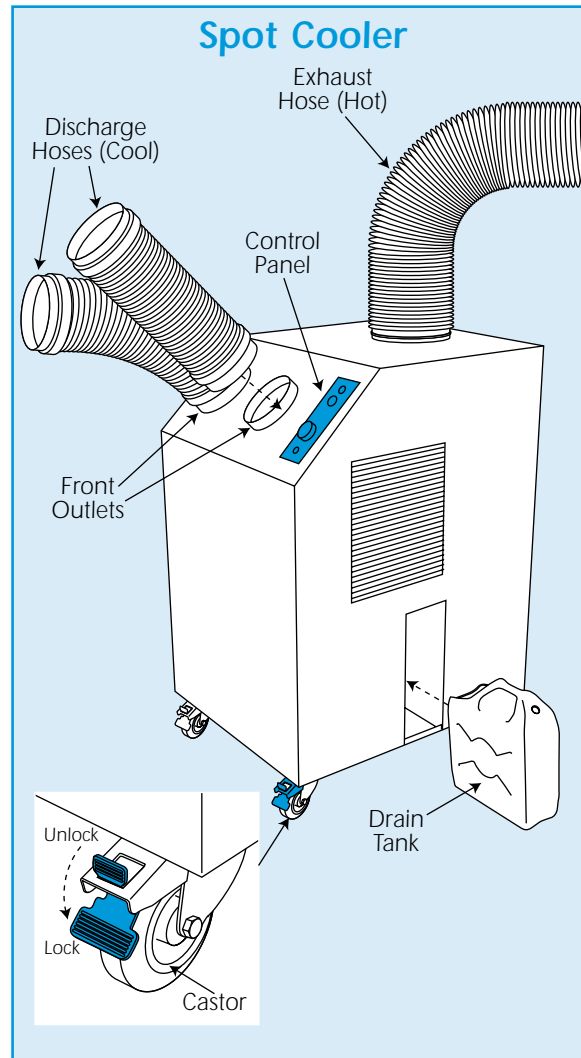

If the temperature in the room is above 35°C, reduce the temperature by opening all doors/windows and operating the unit's fan (without cooling), to circulate the air.

When setting up or restarting, allow the unit to stand/settle for 15 minutes before switching ON.

Do not site the unit close to any surfaces, which may be damaged by heat, cold or moisture.

Set the unit up on a firm, level surface capable of bearing its weight and where motor noise will not be a nuisance.

For additional safety, lock the castor brakes.

Fit the exhaust hose onto the top air outlet of the unit, then extend it to the chosen discharge point.

Keep the hose run as short and straight as possible, sloping up or down. Never operate the unit if the hose is kinked, sagging or punctured.

If chilled air needs to be directed to a particular area, fit the smaller diameter discharge hoses to the front outlets, then extend to the chosen discharge points.

If the discharge hose is kept in its compressed form it remains self supporting.

Check the water drain tank is empty and correctly fitted, the unit has a cut-out facility which switches the unit OFF if the tank becomes full. This will not work unless the float bar is free to swing up and activate the cut-out switch.

Finally, plug the unit into its power supply and switch the supply ON.

## BASIC TECHNIQUES

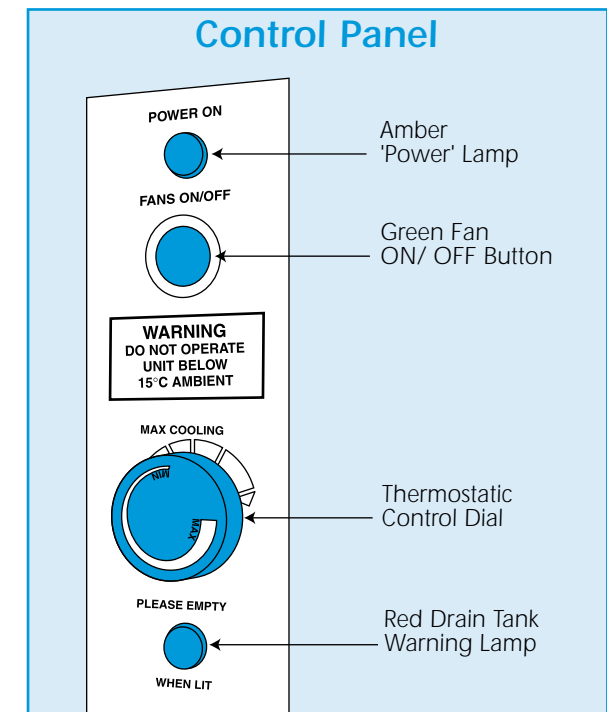

Make sure the amber power supply lamp on the control panel is illuminated, press the green fan button to start the fan.

If chilled air is required turn the thermostatic control dial clockwise to its maximum.

The unit is fitted with a time-delay device, which will prevent the compressor from starting for approximately 4 minutes.

# Know Your Symbols

HSS have created clear Icons to inform the hirer of their responsibilities towards the safe use of hire equipment.

These are designed to reduce the amount of different safety information labels required for each product for hire.

## General use PPE / Warning

Clearly marked minimum PPE will be visible on all equipment,



Correct PPE must be worn



HAV Hand Arm Vibration



Danger Rotating blade



Danger Hot exhaust



Danger Electric shock



Caution Abrasive Wheel



Caution Finger trap

## Fuel and Supply Types



Pe  
Petrol



Di  
Diesel



2t  
2 - Stroke Petrol



EI  
Electric

## Safe Procedures

All hirers must understand and respect the safe procedures of all equipment.

It is the responsibility of the hirer to maintain and return the equipment in a clean condition and good working order.



Ro  
Read OPS Guide



Ou  
Outdoor Use only



HI  
Heavy Lifting



Cd  
Check Oil daily



Cf  
Check Fuel daily



Cw  
Check Water daily



Bc  
Battery Care



Sh  
Safe Height Working



Swl  
Refer to Data Plate



V  
Check Power Voltage Data Plate

## Electrical Safety

Safe wiring procedures.



Ea  
Must be Earthed Class 1

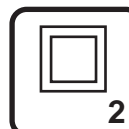

Doi  
Double Insulated Class 2



Enl  
Earth Live Neutral Wire Coding

## Return Responsibility

Charges apply to equipment returned dirty and damaged.



Cc  
Cleaning Charge



Rc  
Repair Charge