

HSS Hire



Power Trowel

For troweling large areas of concrete screed
in a sixth of the time it would take by hand.



Code 44216 / 44229

To do this, **turn the adjuster knob clockwise to increase, anticlockwise to decrease.**

Gently **increase the engine speed until the blades are rotating at a speed suitable for the job** and comfortable for you.

Take your time and don't overdo it. You are more likely to have an accident if you are tired or rushing.

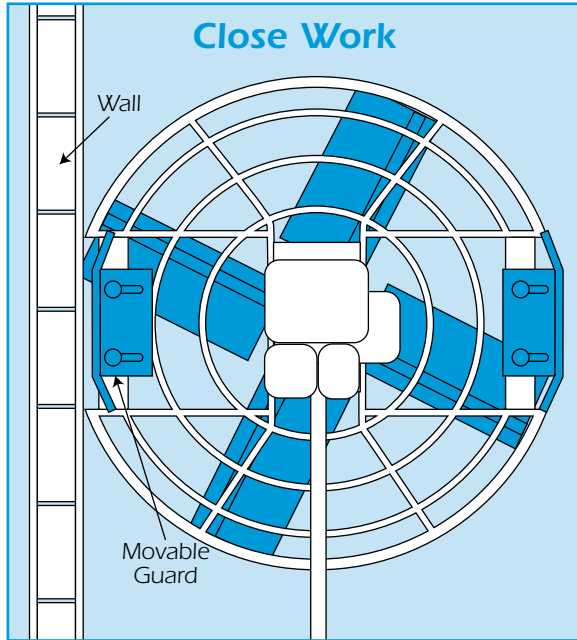

In an emergency, and if you have no other option, release the handlebar and step back. The engine will automatically cut out.

If it is necessary, **the blades can be taken in up to 1/8" to the edge of a wall** without having to finish off by hand. **Loosen the two wing nuts retaining the movable guard, raise the guard clear and re-tighten.**

Final smoothing can be achieved with the blades fitted, but for the best result, use a disk finisher. Available for hire from your local HSS Hire Shop.

To fit the disk, set the blade pitch to minimum, then place the unit centrally over the disk allowing the front edge of the blade to engage with the lip on the top of the disk. The disk will be held in place by the movement of the blades.

EQUIPMENT CARE

Never push the equipment beyond its design limits. If it will not do what you want with reasonable ease, assume you have the wrong type of equipment for the job. Ask at your local HSS Hire Shop for advice.

Keep the equipment clean. You will find this less of a chore if you clean up regularly rather than wait until the end of the hire.

When not in use, **store the equipment somewhere clean, dry and safe** from thieves.

Keep the engine upright at all times. If it should be tipped over, mop up oil and fuel spillages and contact your local HSS Hire Shop for advice.

Regularly check the engines fuel level and top up as required using the correct fuel: lead-free petrol.

Check the engine oil level daily. Let the engine cool, stand it on level ground, withdraw the dip stick and wipe clean, replace and withdraw a second time to verify that the oil level is between Min and Max. Top up as required.

FINISHING OFF

Set the throttle to idle, then switch the engine OFF, followed by the fuel tap.

Give the unit a final clean up ready for return to your local HSS Hire Shop.



... have you been trained

The law requires that personnel using this type of equipment in the workplace must be competent and qualified to do so.

Training is available at HSS Training
0845 766 7799

...any comments?

If you have any suggestions to enable us to improve the information within this guide please e-mail your comments or write to the Safety Guide Manager at the address below
e-mail: safety@hss.com

©HSS Hire Service Group Ltd 2020 No. 657/01

76 Talbot Road, Old Trafford, Manchester, M16 0PQ

www.hss.com

GENERAL SAFETY

For advice on the safety and suitability of this equipment **contact your local HSS Hire Shop.**

There is a serious risk of personal injury if you do not follow all instructions laid down in this guide.

This equipment should be used by an able bodied, competent adult who has read and understood these instructions. Anyone with either a temporary or permanent disability, should seek expert advice before using it.

Keep children, animals and bystanders away from the work area.

 **Never use this equipment if you are ill, feeling tired, or under the influence of alcohol or drugs.**

 **This equipment generates potentially harmful noise levels.** To comply with health and safety at work regulations, **ear defenders must be worn** by everyone in the vicinity.

 **Wear practical, protective clothing, gloves and footwear.** Avoid loose garments and jewellery that could catch in moving parts, tie back long hair.

Exhaust Danger

NEVER operate petrol engines indoors or in a confined space.

The exhaust from the engine contains gases that can Kill.

Ensure the work area is well lit and ventilated.

Always switch OFF the engine when not in use.

Keep flammable materials well away from the engine and exhaust.

Fuel Safety

NEVER refuel while the engine is hot or running. **Never smoke or allow naked lights into the area while refuelling.** **Never inhale fuel vapour.**

ALWAYS mop up spillages as quickly as possible, and change your clothes if you get fuel on yourself.

ALWAYS store fuel in a purpose-made sealed container, in a cool, safe place well away from the work area.

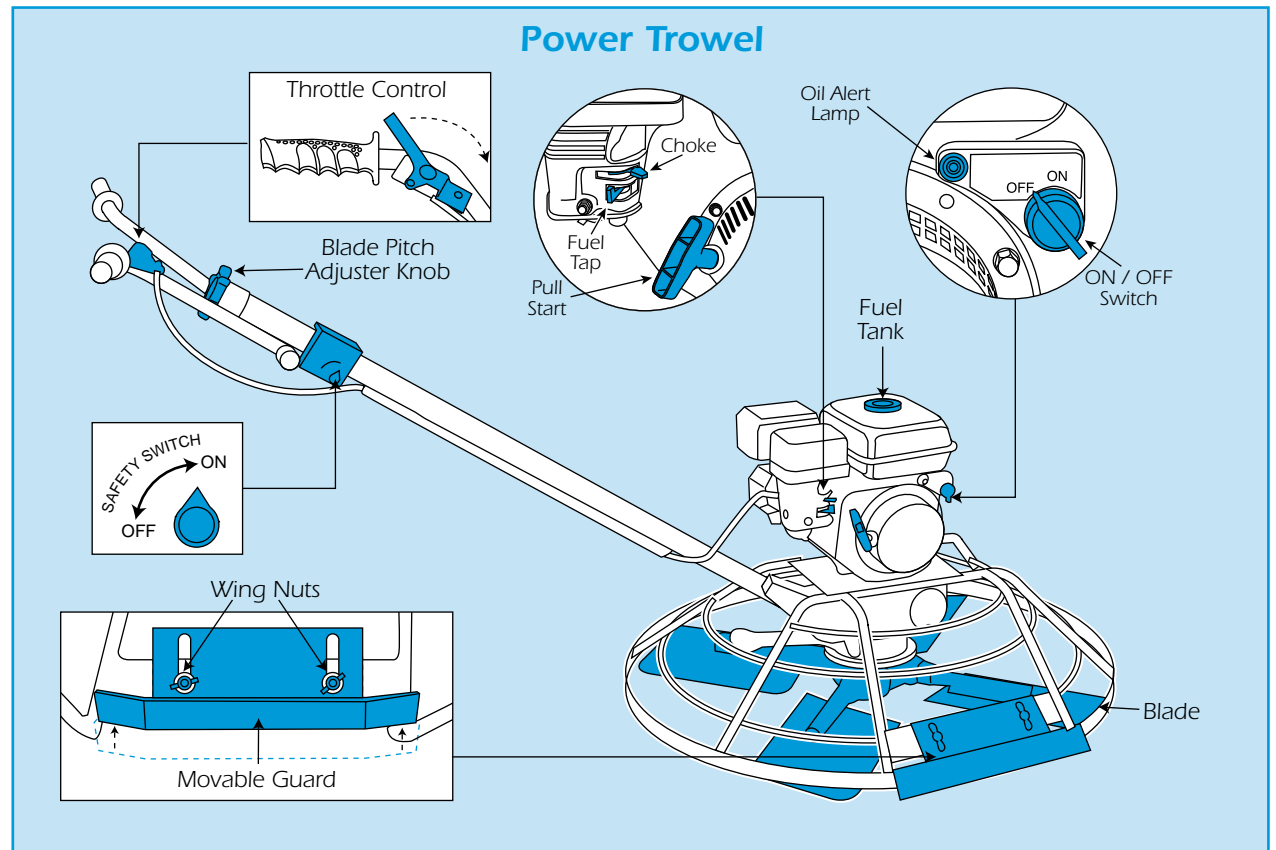

Engines, especially the exhausts, **get very hot** so switch OFF and **allow to cool** before touching them.

Watch your footing. Take special care if working other than on firm, level ground.

Make sure you know how to switch this machine OFF before you switch it ON in case you get into difficulty.

Check the condition of the equipment before use. If it shows signs of damage or excessive wear, return it to your local HSS Hire Shop.

GETTING STARTED

For best results, warm the engine up before placing on the wet concrete.

Place the unit on a smooth level concrete surface, ready to start the engine.

Check the fuel level and fill up as necessary with unleaded petrol.

Turn on the fuel tap, turn the engines ON / OFF ignition switch to ON, then set the choke (fully closed if starting from cold; half open if the engine is still warm).

Power Trowel

Set the throttle control to half way and turn the safety switch on the control bar to the ON position. Then taking a firm hold of the handle bars give the pull start two or three pulls and the engine should start.

Be ready in case the blades begin to rotate.

Turn OFF the choke and close the throttle once the engine has warmed up and then switch the engine OFF.

BASIC TECHNIQUES

If you should get into difficulty when the blades are rotating, close the throttle. If you lose control and release the handle, the engine will stop within $\frac{1}{2}$ of a rotation. To restart the engine, follow the instruction in 'Getting Started'.

Set the unit on the surface to be troweled and start the engine leaving it at idle speed. Set the pitch of the blades for the task. The greater the pitch, the more material the blades will move.

Know Your Symbols

HSS have created clear Icons to inform the hirer of their responsibilities towards the safe use of hire equipment.

These are designed to reduce the amount of different safety information labels required for each product for hire.

General use PPE / Warning

Clearly marked minimum PPE will be visible on all equipment,



Correct PPE must be worn



HAV Hand Arm Vibration



Danger Rotating blade



Danger Hot exhaust

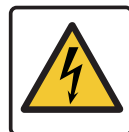

Danger Electric shock



Caution Abrasive Wheel



Caution Finger trap

Fuel and Supply Types



Pe
Petrol



Di
Diesel



2t
2 - Stroke Petrol



EI
Electric

Safe Procedures

All hirers must understand and respect the safe procedures of all equipment.

It is the responsibility of the hirer to maintain and return the equipment in a clean condition and good working order.



Ro
Read OPS Guide



Ou
Outdoor Use only



HI
Heavy Lifting



Cd
Check Oil daily



Cf
Check Fuel daily



Cw
Check Water daily



Bc
Battery Care



Sh
Safe Height Working



Swl
Refer to Data Plate



V
Check Power Voltage Data Plate

Electrical Safety

Safe wiring procedures.



Ea
Must be Earthed Class 1

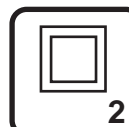

Doi
Double Insulated Class 2



Enl
Earth Live Neutral Wire Coding

Return Responsibility

Charges apply to equipment returned dirty and damaged.



Cc
Cleaning Charge



Rc
Repair Charge