



Podium & Anti Surf Step

For essential maintenance and repair work, these podium steps provide low level height access with full guardrail protection



Codes 80840 / 80871 / 80838 / 80842

WIND DESCRIPTION

Wind Description	Beaufort Scale	Beaufort No.	Speed in m.p.h	Speed in m/sec
Medium Breeze	Raises dust and loose paper, twigs snap off	4	8-12	4-6
Strong Breeze	Large branches in motion, telegraph wires whistle	6	25-31	11-14
Gale Force	Walking is difficult	8	39-46	17-21

EQUIPMENT CARE

Only use this piece of equipment for its intended purpose, as a work station.

Never push the equipment beyond its design limits. If it will not do what you want with reasonable ease and speed, assume you have the wrong equipment for the job. Contact HSS Hire for advice.

Keep the equipment clean - you will find this less of a chore if you clean it regularly, rather than wait until the end of the hire period.

When not in use, store the equipment somewhere clean, dry and secure.

FINISHING OFF

Exit the podium step and close it simply the reverse way explained in Opening the Podium Step section.

Collect all parts together and give them a final clean up ready for return, to HSS Hire.



... have you been trained

The law requires that personnel using this type of equipment in the workplace must be competent and qualified to do so. Training is available at HSS Training 0845 766 7799

...any comments?

If you have any suggestions to enable us to improve the information within this guide please e-mail your comments or write to the Safety Guide Manager at the address below e-mail: safety@hss.com

©HSS Hire Service Group Ltd 2020 No. 324/01
76 Talbot Road, Old Trafford, Manchester, M16 0PQ

www.hss.com

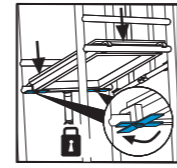

3 Push the platform towards the back of the unit until it is in contact with the rear folding guardrail frame. Lock the platform retaining plates.

PRE-OPERATION CHECKLIST

1. Check all castors are secure and the fixing bolts are tightened correctly.
2. Check all wheel brakes operate and lock the wheel and castor into position.
3. Check the tubes and aluminium components of the podium step. There should not be any cracks or excessive dents or distortion.
4. Check there is free movement of all hinge points of the podium step.
5. Check the plywood platform. There should not be excessive contamination, cracking, holes or damage, including any missing or damaged rivet fixings.
6. Check that the podium step locking mechanisms are operating and locking correctly. Ladder claws and locks, gate claw and lock, rear folding frame elbow locking joints and the platform locking tabs.
7. Make sure the total load (1 person plus tools & materials) is not be more than 150kg.
8. Make sure the castors are pointing outwards and the wheel brakes are locked.
9. Check the ladder section is located correctly.
10. Make sure the podium step is on flat, level, dry and firm ground.
11. Make sure the podium step is correctly positioned to avoid over reaching.
12. Make sure the platform is at the correct height.
13. Make sure the safety gate is shut and locked once you are on the platform.

1 Ensure the platform is towards the back of the unit and in contact with the rear folding guardrail frame.



2 Using the ladder section, climb onto the platform of the work station.



RELEASING THE GATE

Release the locking claw and rotate the gate to the position shown.

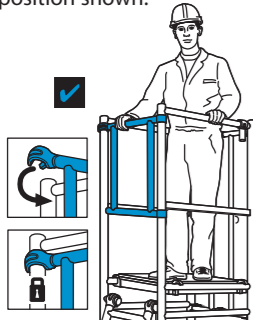

CLOSING THE GATE

Close the gate ensuring the locking claw has engaged.

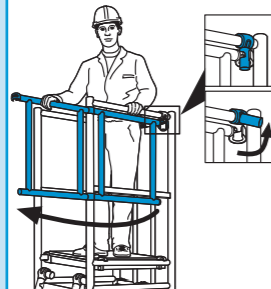

ALTERING THE PLATFORM HEIGHT

1 Rotate the platform upwards and unlock both platform retaining plates.

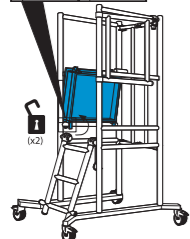
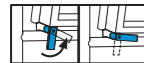

2 Position the platform at the lower level.

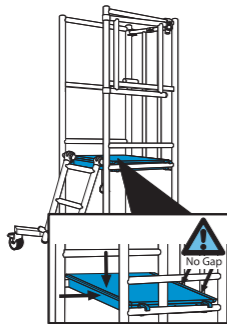

GENERAL SAFETY

For advice on the safety and suitability of this equipment contact HSS Hire.

There is a serious risk of personal injury if you do not follow all instructions laid down in this guide.

The hirer has a responsibility to ensure that all necessary risk assessments have been completed prior to the use of this equipment.

This equipment should only be used by an operator who has been deemed competent to do so by his/her employer.

This equipment should be used by a competent adult who has read and understood these instructions. Anyone with either a temporary or permanent disability, should seek expert advice before using it.

Keep children, animals and bystanders away from the work area. Cordon off a NO GO area using cones and either barriers or tape, available for hire from HSS Hire.

 **Never use** this equipment if you are ill, feeling tired, or under the influence of alcohol or drugs.

 **Wear practical, protective clothing, gloves, footwear and a protective hard hat.** Avoid loose garments and jewellery that could catch in moving parts, tie back long hair.

Do not work near flammable gases or liquids, petrol or paint thinner fumes for example.

Make sure you know how to use this equipment safely and are aware of its limitations before you use it.

Make sure that everyone is warned of what you are doing. Never overload the podium step. The podium step maximum safe working load is 150kg. This includes any tools and materials.

The maximum number of occupants must not exceed one.

Never use the podium step if any part is damaged or shows signs of excessive wear.

Never move the podium step when a person is standing on it.

Never over-reach or lean too far over the side of the podium step.

Never use the podium step near overhead power lines or similar hazards.

Never carry out jobs that require excessive sideways force. Forces should never exceed 10kg when working with the side of the podium step towards the work. Excessive sideways forces may cause the podium step to overturn or the wheels to slip.

Never lean anything against the podium step e.g. ladders, steps or materials.

Never climb up outside of the guardrail.

Never stand the podium step on soft, loose, slippery, sloping or uneven ground.

Never use the podium step outside in heavy rain or strong winds (see Wind description).

Never stand on the guardrails, boxes, stepladders or other objects on the platform, to gain additional working height.

Never suspend the podium step from another structure or level.

Never use the podium step as a method of gaining access to another structure or level.

Always carry out a Risk Assessment for each job before you start work, to ensure the work station is the appropriate method of access.

Always check the work station for damage before you use it. If it shows any signs of damage return the unit to HSS Hire.

GETTING STARTED

Never use the HSS Podium and Anti Surf Podium Steps until you have fully read and understood this User Guide and the machine has been properly set up using the information it contains.

Before you start using podium step make sure that the floor area where the podium is to be erected is able to bear its weight and the weight of any load.

When moving and positioning the podium step, ensure that all wheel brakes are unlocked.

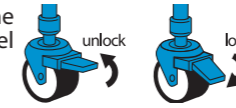

WARNING

NEVER MOVE OR POSITION THE PODIUM STEP WHEN ANYONE IS STANDING ON THE PLATFORM OR THERE ARE TOOLS OR ANY OTHER OBJECTS THAT CAN FALL DOWN WHILE THE PLATFORM IS IN MOTION

BASIC TECHNIQUES

OPENING THE PODIUM / ANTI SURF STEP

1 Place the closed unit in the upright position. Unlock all 4 castors there are 2 on Anti Surf Step

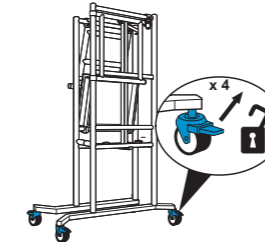

2 Release the locking claw that locks the two side frames together.



3 Open the side frames, which will allow the rear folding guardrail frame to unfold. Ensure the rear folding frame is fully open and both elbow joints are locked.



4 Slide the platform towards the front of the unit (the open end) so that the platform claw is clear of the retaining bar.



5 Rotate the platform down and locate the platform claws on the horizontal member of the right hand side frame. Push the platform back towards the back of the unit until it is in contact with the rear folding guardrail frame. Ensure the claws are sitting on the tube and not the plates.

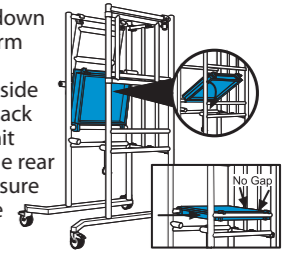

POSITIONING THE PODIUM / ANTI SURF STEP

1 Remove the ladder from the left hand side frame by releasing the ladder locking tab and the two locking claws, situated at the top of the ladder frame.

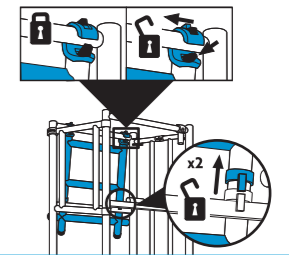

2 Locate the ladder claws over the spigots on the left and right hand side frame. Ensure the claws are locked.



3 Rotate the ladder down, using the claws as pivots. Locate the bottom of the ladder over the base frame as shown below.

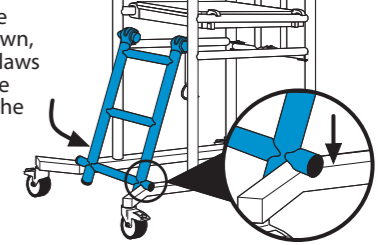

ACCESSING THE PODIUM / ANTI SURF STEP

Lock all four wheel brakes (two on Anti surf), with all of the castors pointing outwards, as shown in the diagram:

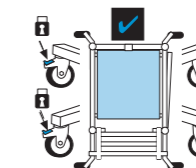

Never climb on the podium step until you have checked that

- 1. the ladder is secure and positioned correctly.**
- 2. the platform is secure and positioned correctly.**
- 3. all castors are positioned correctly.**
- 4. all castors wheels are locked.**

IDENTIFIER

ANTI-SURF PODIUM STEP

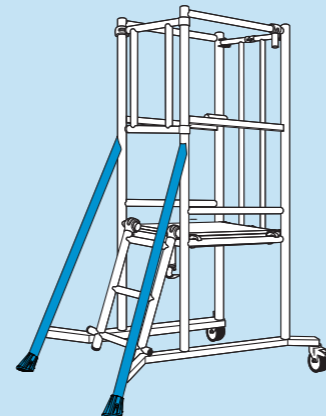
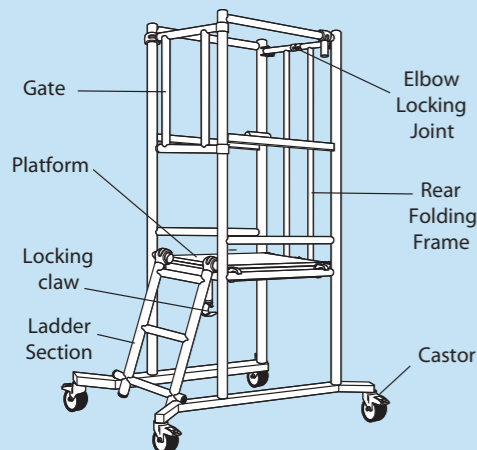

Know Your Symbols

HSS have created clear Icons to inform the hirer of their responsibilities towards the safe use of hire equipment.

These are designed to reduce the amount of different safety information labels required for each product for hire.

General use PPE / Warning

Clearly marked minimum PPE will be visible on all equipment,



Correct PPE must be worn



HAV Hand Arm Vibration



Danger Rotating blade



Danger Hot exhaust



Danger Electric shock



Caution Abrasive Wheel



Caution Finger trap

Fuel and Supply Types



Pe
Petrol



Di
Diesel



2t
2 - Stroke Petrol



EI
Electric

Safe Procedures

All hirers must understand and respect the safe procedures of all equipment.

It is the responsibility of the hirer to maintain and return the equipment in a clean condition and good working order.



Ro
Read OPS Guide



Ou
Outdoor Use only



Hi
Heavy Lifting



Cd
Check Oil daily



Cf
Check Fuel daily



Cw
Check Water daily



Bc
Battery Care



Sh
Safe Height Working



Swl
Refer to Data Plate



V
Check Power Voltage Data Plate

Electrical Safety

Safe wiring procedures.



Ea
Must be Earthed Class 1

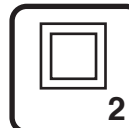

Doi
Double Insulated Class 2



Enl
Earth Live Neutral Wire Coding

Return Responsibility

Charges apply to equipment returned dirty and damaged.



Cc
Cleaning Charge



Rc
Repair Charge