

Misfires

If the Cartridge Hammer fails to fire, continue to hold it against the work for at least 30 seconds before assuming the cartridge has failed.

You can then try again, advancing a fresh cartridge into the firing position by pulling the cartridge strip up one position and trying again. Always point the tool at the ground while doing this. Never look down the barrel. If the Cartridge Hammer fails a second time, wait a further 30 seconds, remove the cartridge strip, place in the toolbox and mark it. Strips containing faulty cartridges must only be returned to your nearest HSS Hire Shop and the manager informed. Do not dispose of them in any other way.

CHANGING NAIL SIZE

If you intend using more than one size of nail with this equipment, it is extremely important that you fully understand the following instructions.

Failure to follow these instructions carefully may result in property damage and personal injury.

Make sure that there is a strip of unused cartridges in the tool.

Remove any remaining strip of nails from the magazine. Close the magazine and on a suitable hard base material, e.g. concrete (not wood), attempt to fire the tool.

When the tool fails to fire, the magazine will be empty and the different nail size can be loaded into the magazine.

If you are unsure about this procedure, STOP and contact your local HSS Hire Shop for advice.

EQUIPMENT CARE

Never push the equipment beyond its design limits. If it will not do what you want with reasonable ease and speed, assume you have the wrong Cartridge Hammer for the job. Contact your local HSS Hire Shop for advice.

Keep the equipment clean - you will find this less of a chore if you clean it regularly, rather than wait until the end of the hire period.

Use only nails and cartridges supplied by HSS. Those from any other sources may be dangerous and could damage the tool.

When not in use, **store the equipment somewhere clean, dry away from heat/ignition sources and safe from thieves and unauthorised users.**

FINISHING OFF

Remove any remaining strip of nails from the magazine. Close the magazine and on a suitable hard base material, e.g. concrete (not wood), attempt to fire the tool.

When the tool fails to fire, the magazine is empty. Pull the cartridge strip out through the top of the tool and place all nails and cartridges, in the tool's carrying case.

Finally, clean off any dust or dirt before packing the tool away in its case and returning it to your local HSS Hire Shop so that we can dispose of unused cartridges correctly and safely.

The Good Fixing Guide

Timber to Concrete:	22-32mm
Timber to Brickwork:	Variable (test first)
Steel to Steel:	10-14mm
Timber to Steel:	17-27mm

Note: Select nail length by adding above depth to thickness of item to be secured

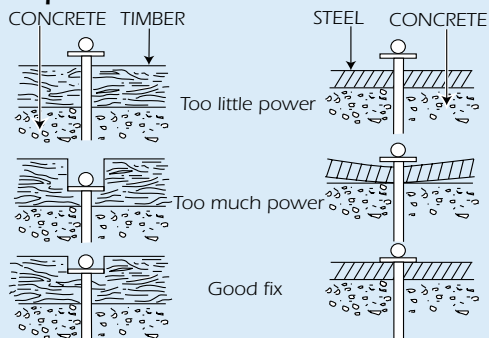

Example showing nail fixing timber to concrete

Example showing nail fixing steel to concrete



... have you been trained

The law requires that personnel using this type of equipment in the workplace must be competent and qualified to do so.

Training is available at HSS Training
0845 766 7799

...any comments?

If you have any suggestions to enable us to improve the information within this guide please e-mail your comments or write to the Safety Guide Manager at the address below
e-mail: safety@hss.com

©HSS ProService Ltd. 2023 No. 385/02

Building Two, Think Park, Mosley Road,

Trafford Park, M17 1FQ

www.hss.com

385/02

Operating & Safety Guide 385

HSS Hire



Rapid Fire Cartridge Hammer

A fully automatic Cartridge Hammer with contact only firing mechanism.



Code 52246

GENERAL SAFETY

For advice on the safety and suitability of this equipment **contact your local HSS Hire Shop.**

There is a serious risk of personal injury if you do not **follow all instructions** laid down in this guide.

The hirer has a responsibility to **ensure that all necessary risk assessments have been completed** prior to the use of this equipment.

This equipment should only be used by an operator who has been deemed competent to do so by his/her employer.

This equipment should be used by an able bodied, competent adult who has read and understood these instructions. Anyone with either a temporary or permanent disability, should seek expert advice before using it.

Keep children, animals and bystanders away from the work area. Cordon off a NO GO area using either cones, barriers or tape, available for hire from your local HSS Hire Shop.

This Cartridge Hammer must only be operated by adults over 18

who have read and understood these instructions.

 **Never use this equipment if you are ill, feeling tired, or under the influence of alcohol or drugs.**

 **Safety goggles MUST be worn by everyone in the work area.**

 **This equipment generates potentially harmful noise levels.** To comply with health and safety at work regulations, **ear defenders must be worn** by everyone in the vicinity.

 **Wear practical, protective clothing, gloves and footwear.** Avoid loose garments and jewellery that could catch in moving parts, tie back long hair.

Ensure the work area is well lit and ventilated, if in doubt, ask about lighting and ventilation equipment at your local HSS Hire Shop.

Do not work near flammable gases or liquids, petrol or paint thinner fumes for example. **Keep combustible materials at a safe distance** - at least 5m.

Make sure that everyone is warned of what you are doing.

Never load the Cartridge Hammer until you are ready to use it to make a fixing and, once loaded, never point it at anyone – including yourself.

Never use the Cartridge Hammer if anyone is close enough to be at risk from flying debris or misfires.

Never use the Cartridge Hammer in fume/gas-laden atmospheres where there is a risk of explosion or fire – for example, in paint stores and sewers.

Make sure of your footing before operating the Cartridge Hammer. **Never work from an unstable platform** such as ladders, steps or anywhere else where there is a risk of slipping or falling – the recoil could throw you off balance.

Never make fixings in anything containing hidden pipes or electrical wiring. If in doubt, use a metal detector or Cable Avoiding Tool to locate such hazards.

Before cleaning or making any adjustments to the Cartridge Hammer, unload it by pulling the cartridge strip out through the top.

Never leave the Cartridge Hammer loaded and unattended – even for a moment.

Store the Cartridge Hammer (together with spare cartridges and fixings) **in its case**, somewhere it cannot be reached by children or unauthorised users.

Check the condition of the equipment before use. If it shows signs of damage or excessive wear, return it to your local HSS Hire Shop.

COSHH information sheets are available from your local HSS Hire Shop.

GETTING STARTED

It is essential to familiarise yourself with all the controls before starting.

Ensure the method of fixing is appropriate to the object being fixed. The base material should be at least 4mm thick for steel, 100mm for concrete and resistant to impact damage.

Ensure the method of fixing is suitable for the surface you are fixing to, for example concrete, brick and steel. In particular, the tool must not be used to make fixings in partition walls, ceilings, soffits.

Select the appropriate cartridge for the job. In most cases, standard red cartridges are more than adequate. However, there may be times (when fixing into steel) when the more powerful black cartridges are needed. **If in doubt, contact your local HSS Hire Shop for advice.**

Adjust the Cartridge Hammer's power regulator to give the required penetration.

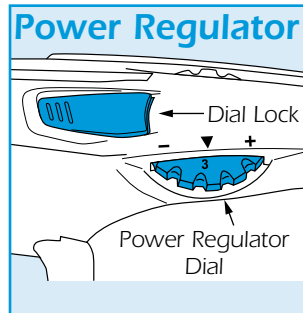

Start at the number 1 setting, make a test fixing (see Basic Techniques) **then reset the regulator dial if required** and re-test until you have an acceptable fixing.

To adjust the setting, **depress the dial lock, turn dial anticlockwise to increase** and clockwise to decrease **then release the dial lock.**

BASIC TECHNIQUES

To load the Cartridge Hammer, open the magazine. Push in the release button and slide the cover down.

Carefully insert the strip of nails into the guide with points facing forward. Firstly, insert and raise the strip, then slide the cover up until it clicks in place.

There is an indicator fitted to the magazine, which shows a red marker when down to the last two nails.

Feed the cartridge strip into the bottom of the tool's grip as far as it will go. **You are now ready to fire.**

To make the fixing, hold the Cartridge Hammer with both hands and press the fastener guide against the work until the nosepiece is fully compressed – you may

Loading the Magazine

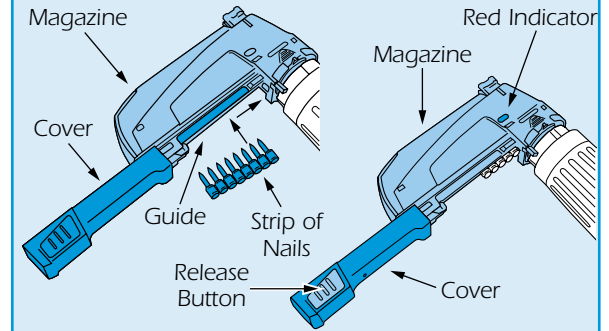

hear a click as the fastener guide slides back and arms the firing mechanism.

Now, having braced yourself against the recoil, **squeeze the trigger and the tool should fire.**

Release the trigger and move the tool away from the surface. Note that the mechanism will automatically load the next cartridge and fixing ready for firing.

Do not drive nails near the edges or corners. In steel, edges should be at least 15mm away; 80mm in concrete. **Do not try to make a fixing twice in the same place.**

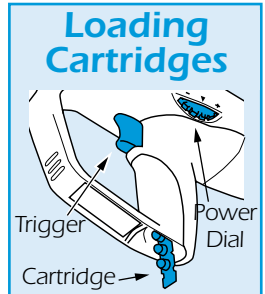

Rapid Fire Cartridge Hammer

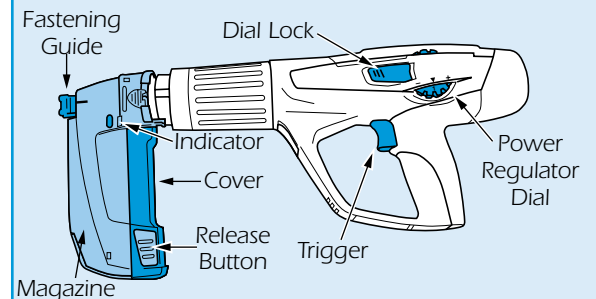

Over-driving

Over-driving normally results from using fixings that are too short, but it can happen accidentally – if the material you are driving into is flawed. **Whatever the cause, it may damage the stop ring** – so, if you find that the automatic loading cycle fails, **return the tool to your local HSS Hire Shop for exchange.**

NEW TYPE DX MACHINE

Product overview (fastening tool)

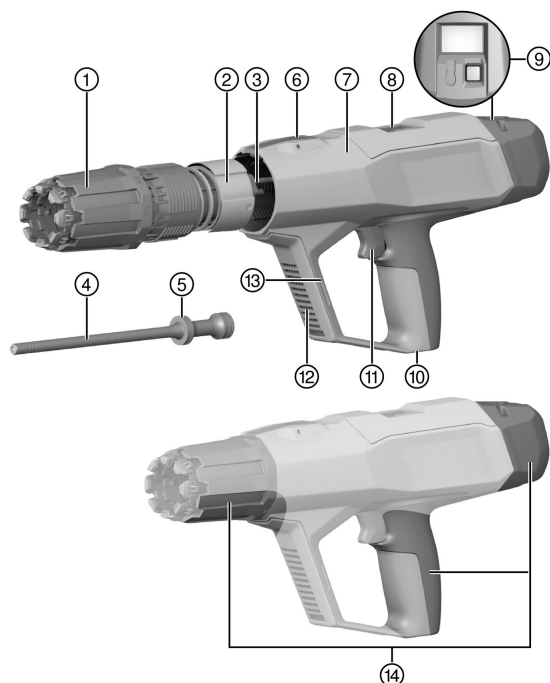

- ① Selector ring for driving energy
- ② Guide sleeve
- ③ Exhaust gas piston return unit
- ④ Piston
- ⑤ Piston rings
- ⑥ Release button for selector ring for driving energy
- ⑦ Housing
- ⑧ Cartridge barrel (ejection)
- ⑨ Operating button at display
- ⑩ Cartridge barrel (insertion)
- ⑪ Trigger
- ⑫ Air vents
- ⑬ Installation interface for accessories
- ⑭ Gripping surfaces

Product overview (fastener guides)

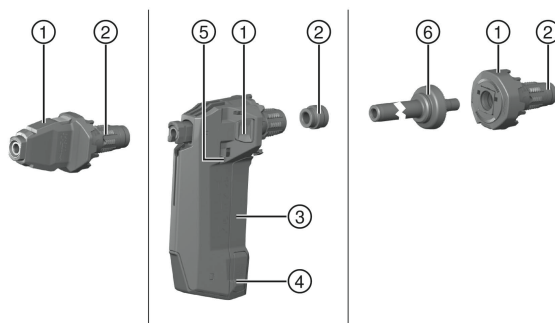

- ① Release button (fastener guide)
- ② Buffer
- ③ Magazine shutter
- ④ Release button (magazine shutter)
- ⑤ Nail detector with reload indicator (red)
- ⑥ Interchangeable fastener guide nosepiece

Controls on the fastening tools

The controls on the fastening tool are as follows:

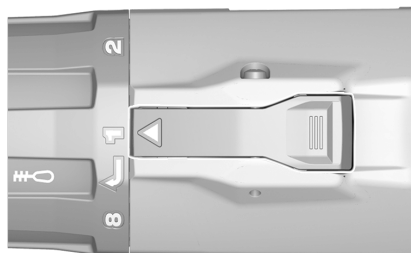

Release button for selector ring for driving energy

The button unlocks the selector ring for driving energy or is used for removal of the exhaust gas piston return unit.

Minimum distances and edge distances

You must always observe certain minimum distances and spacing when driving fasteners. They can differ depending on the product.

Comply with the instructions for use in the operating instructions of the fastener used, in the Hilti Direct Fastening Technology Manual or the corresponding local Hilti 'Technical Guide to Fastening Technology'.

Fastening to concrete or steel

Description	Concrete	Steel
minimum distance from the edge of the base material to the fastener	≥ 70 mm	≥ 15 mm
minimum center-to-center distance between fasteners	≥ 80 mm	≥ 20 mm
minimum base-material thickness	≥ 100 mm	Follow the instructions in the operation of the fastener!

Know Your Symbols

HSS have created clear Icons to inform the hirer of their responsibilities towards the safe use of hire equipment.

These are designed to reduce the amount of different safety information labels required for each product for hire.

General use PPE / Warning

Clearly marked minimum PPE will be visible on all equipment,



Correct PPE must be worn



HAV Hand Arm Vibration



Danger Rotating blade



Danger Hot exhaust

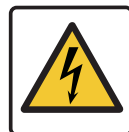

Danger Electric shock



Caution Abrasive Wheel



Caution Finger trap

Fuel and Supply Types



Pe
Petrol



Di
Diesel



2t
2 - Stroke Petrol



EI
Electric

Safe Procedures

All hirers must understand and respect the safe procedures of all equipment.

It is the responsibility of the hirer to maintain and return the equipment in a clean condition and good working order.



Ro
Read OPS Guide



Ou
Outdoor Use only



HI
Heavy Lifting



Cd
Check Oil daily



Cf
Check Fuel daily



Cw
Check Water daily



Bc
Battery Care

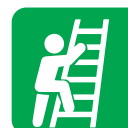

Sh
Safe Height Working



Swl
Refer to Data Plate



V
Check Power Voltage Data Plate

Electrical Safety

Safe wiring procedures.



Ea
Must be Earthed Class 1

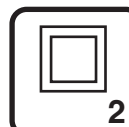

Doi
Double Insulated Class 2



Enl
Earth Live Neutral Wire Coding

Return Responsibility

Charges apply to equipment returned dirty and damaged.



Cc
Cleaning Charge



Rc
Repair Charge