

EQUIPMENT CARE

Never use the equipment for anything other than its intended purpose. If it will not do what you want, assume you have the wrong equipment for the job. Contact HSS Hire for advice.

Handle the equipment with care. Avoid dropping it, knocking it or otherwise exposing it to damage.

Never expose the equipment to excessive moisture, dust or dangerous / corrosive chemicals.

Keep the equipment clean. You will find this less of a chore if you clean it regularly, rather than waiting until the end of the hire period.

If the RCD trips, turn off the power, unplug everything connected to it and turn the power back on - reset the RCD. If it trips again, contact HSS Hire for advice.

NOTE

If you find

Cuts, abrasions or severe kinks in any lead.

Cracked, chipped or otherwise damaged plugs.

Water or other liquids that may have penetrated plugs, casings or any electrical connection – including the RCD itself.

Return the equipment to HSS Hire.

FINISHING OFF

Switch OFF and unplug all electrical equipment connected to the lead / box.

Unplug all cables and dust them down with a soft cloth.

Finally, neatly coil the cables ready for return to HSS Hire.



... have you been trained

The law requires that personnel using this type of equipment in the workplace must be competent and qualified to do so.

Training is available at HSS Training
0845 766 7799

...any comments?

If you have any suggestions to enable us to improve the information within this guide please e-mail your comments or write to the Safety Guide Manager at the address below
e-mail: safety@hss.com

©HSS Hire Service Group Ltd 2012 No. 621/03

Group Office: 25 Willow Lane, Mitcham, Surrey CR4 4TS

Web Site: <http://www.hss.com>

Operating & Safety Guide 621

HSS Hire

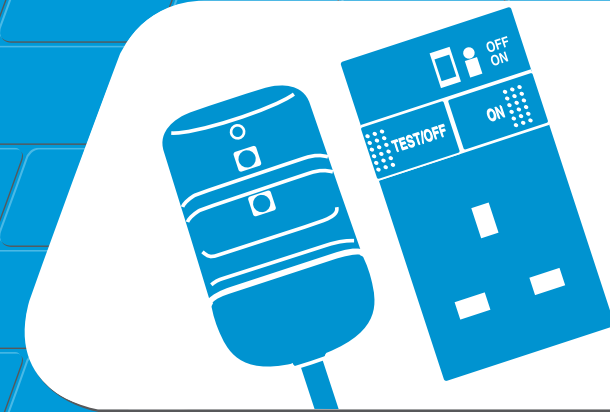

Residual Current Device (RCD)

A safety essential for power tools & electrical equipment, reducing the risk of electrical shock



Code 40970/72/91/92/93 40980

GENERAL SAFETY

For advice on the safety and suitability of this equipment contact HSS Hire.

There is a serious risk of personal injury if you do not follow all instructions laid down in this guide.

The hirer has a responsibility to ensure that all necessary risk assessments have been completed prior to the use of this equipment.

This equipment should be used by an able bodied, competent adult who has read and understood these instructions. Anyone with either a temporary or permanent disability, should seek expert advice before using it.

Keep children, animals and bystanders away from the work area.

 Never use this equipment if you are ill, feeling tired, or under the influence of alcohol or drugs.

Always switch OFF and unplug the equipment when not in use. Wait for moving parts to stop before putting the tool down and never leave electrical equipment switched ON and unattended.

Keep transformers, junction boxes, extension cable reels and RCDs at a safe distance from the work area.

Keep cables clear of any exposed moving parts or cutting edges that the equipment being powered may have.

ELECTRICAL SAFETY

Keep electrical equipment dry at all times. Using it in wet or very damp conditions can be dangerous.

HSS RCDs come in various types – light-duty 230V RCD plugs and adaptors and heavy duty 110V, 230V & 415V RCD boxes.

WARNING - TRANSFORMER

When used with a transformer, an RCD will only protect the user if fitted between the transformer and the tool being used.

An RCD fitted between the power supply and the transformer only protects up to the transformer.

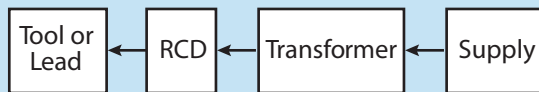

Be sure to choose the right RCD for the job, matching its voltage to that of the supply it is to protect.

Handle plugs and flexes with care. Avoid running cables through water, over sharp edges, or where they could trip

someone.

Never strain leads by using them to move or carry equipment.

If the RCD fails, or if a lead gets damaged, return it. Never attempt to repair it yourself.

Always switch OFF and unplug electrical equipment before attempting to maintain or adjust it in any way. Never leave electrical tools unattended while they are plugged in and switched ON

GETTING STARTED

Using an RCD

Always plug the RCD into the power source.

*see note on using transformers.

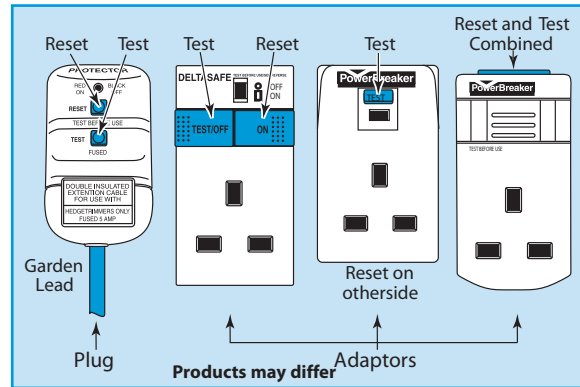

If the setup includes a transformer, fit a 110V RCD to the transformer's 110V outlet socket.

Never plug an RCD into an extension lead's outlet socket. It won't respond to faults in the lead.

Before starting work, check that the RCD is working properly - for absolute safety, test it twice.

Familiarise yourself with the buttons.

Press the reset button to turn the ON / OFF indicator to red, then push the test button.

Safety Cut Outs

All HSS Transformers are protected by thermal disrupters, circuit breakers, or fuses, and comply with British Standard BS3535. Their output sockets comply with British Standard BS4343.

If the ON / OFF indicator trips back to white, all is well. Simply press the reset button once more, the ON / OFF indicator will turn red, and the RCD is ready for use.

On some RCDs, the reset button cannot be operated until the power supply has been switched off, then back on.

If using 230V OR 110V HEAVY DUTY RCD BOXES.

Turn the RCD on by lifting the cover and clicking the switch up.

Press the white button (marked T) at the side of the switch, the RCD will trip and the switch will move down.

Test again, then reset the switch to ON and plug in the tool to be used.

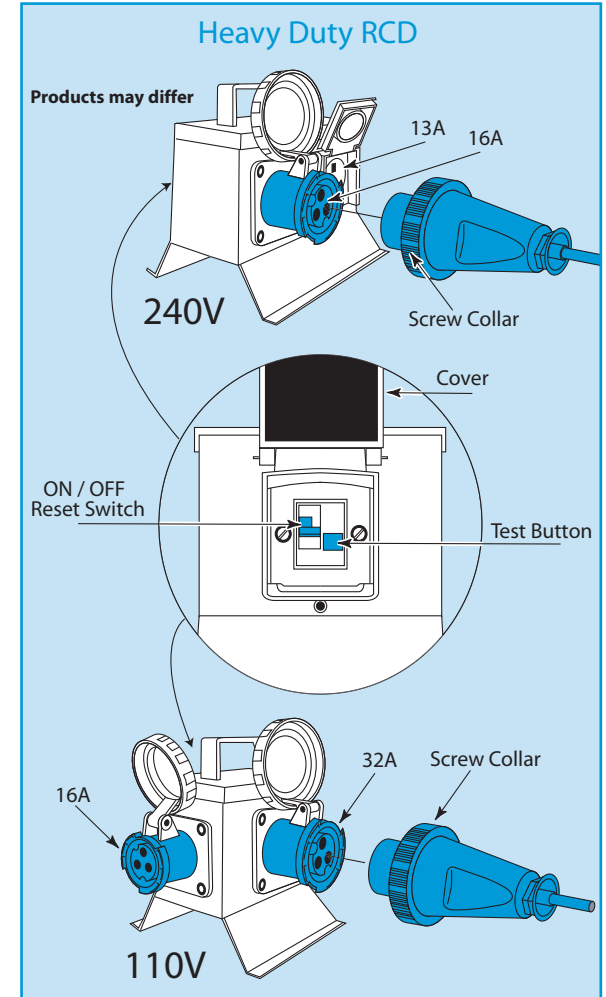

The 16A and 32A Industrial sockets on the Heavy Duty RCD's are designed to be used with either normal 16A and 32A plugs or with splashproof plugs fitted with a securing screw collar.